

2016 Exhibition of School Planning and Architecture

Officer Secondary College

Category: New Construction

Officer
Victoria, Australia

Officer Secondary College



Rhiannon Slatter

Officer Secondary College



Central Axis through the College

Community Environment: Officer Secondary College was conceived as a key element of the wider Officer Education Hub that was designed as a core community-building foundation for the surrounding rapidly developing suburban community. Generating strong community connections was fundamental to the success of the project, and therefore it was essential that the planning and community engagement process facilitated this from the outset. Our team engaged in extensive collaborations with diverse stakeholders, including Cardinia Council, Places Victoria and the wider community, to ensure that the desired level of connection to the township and sharing of facilities could be achieved.



Rhiannon Slatter

Student Entrance

Community Environment: Our team engaged in extensive collaborations with diverse stakeholders, including Cardinia Council, Places Victoria and the wider community, to ensure that the desired level of connection to the township and sharing of facilities could be achieved. Developed in collaboration with Cardinia Shire Council, the central Administration and Multipurpose Community Hub was designed to be the iconic main entry of the College and the education precinct as a whole. The Hub provides a range of facilities designed for use by the College and Specialist School during class hours, and for authorised community use on afternoons and weekends. Facilities include an indoor multipurpose 3 court stadium, a performing arts space that can be converted into a performance space or a series of practice rooms, and kitchen and barista facilities.



Rhiannon Slatter

Learning Community

Learning Environment: The learning environment at Officer Secondary College is designed to support a range of learning styles, encourage students to become active learners, support a 21st century pedagogical approach, and encourage community integration.

The College features two dedicated teaching buildings which were developed over two levels and planned as a series of open plan learning communities. Each of the six learning community includes a diversity of spaces to support different modes of learning, including large collaborative spaces that can accommodate up to 50 students together with informal, social and creative learning areas. The design allows teachers to move through the spaces throughout the day, utilising the areas most suited to the varied learning needs of their students.



Multi-purpose Lab

Learning Environment: A separate Specialty Building houses shared areas for science, art and materials technology. The space recognises that project work may require a combination of activities and that teachers may require the ability to move students between theoretical and practical activities during a single teaching session.



Double storey street interface

Physical Environment: Officer Secondary College was designed to respond to the surrounding urban context and to give students a sense of individual autonomy whilst at the same time belonging to a broader community. The masterplanning approach gives the sense that the secondary school campus is an extension of the surrounding township as opposed to a highly separated learning institution, with the double storey configuration referencing the future streetscape of commercial development opposite.



Rhiannon Slatter

Central Plaza

Physical Environment: Key consideration of public, private and privileged spaces was crucial during the planning of Officer Secondary College in order to address the relationship with the co-located Officer Specialist School, enable strong community connection, and support the school's student-centred pedagogical approach. The College buildings were orientated to create a sense of street activation as well as ensure optimum natural light within the learning spaces. The planning process focused on creating indoor/outdoor connections and access-ways both into the College and between facilities that support the school's evolving programs, shape a sense of dignity and delight in learning for students, and create a welcoming and iconic identity within the community.



Rhiannon Slatter

Upper level learning community

Planning Process: Our team worked extensively with DET, the school planning committee and the Officer community to develop an educational vision and Masterplan for an Educational Precinct which would co-locate Officer Secondary College and Officer Specialist School on a single campus, and form the vibrant heart of this growing community. The Officer Secondary College planning process was extraordinarily thorough, robust and comprehensive, with planning committee members fully engaged in writing the educational specification, participating in workshops, school tours, design review and development.



Social Gathering Space

Planning Process: The planning process involved the development of a masterplan that considered the relationships between the two schools, their relationship with the entire community and viewed the site as an entire educational precinct. An inclusive and collaborative planning process has delivered contemporary learning spaces that support the College's personalised pedagogical approach, generate strong community connections, and shape a vibrant, truly community integrated learning environment.

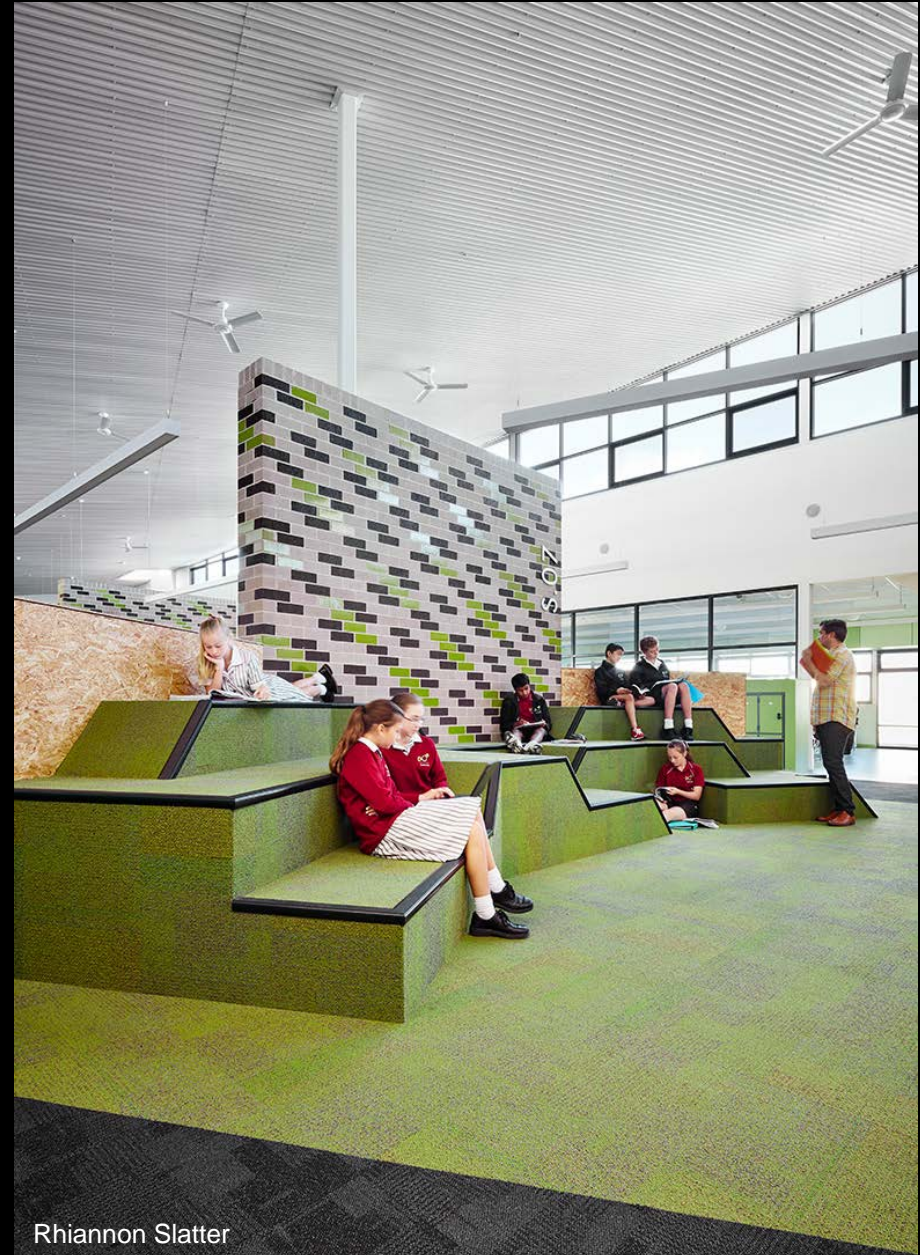

Rhiannon Slatter

Floor Plan

Learning Communities – Ground Floor



Floor Plan

Learning Communities – First Floor



Floor Plan

Specialist Building



Floor Plan

Administration Building/Games Hall

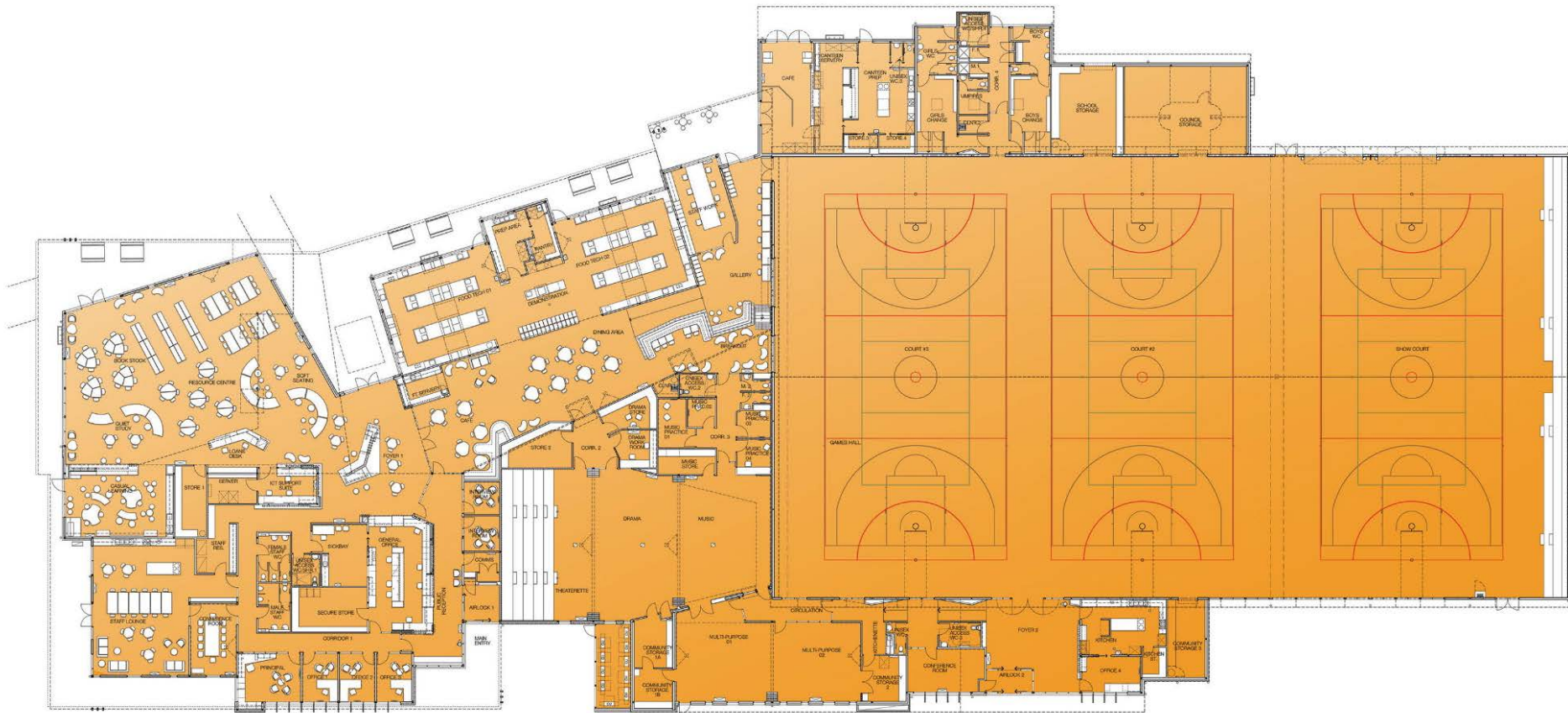

Exhibition of School Planning and Architecture

Project Data

Submitting Firm :	Clarke Hopkins Clarke Architects
Project Role	Architect
Project Contact	Wayne Stephens
Title	Partner
Address	115 Sackville Street
City, State or Province, Country	Collingwood, Victoria, Australia
Phone	+61 3 9419 4340

Construction Firm:	Melbcon
Project Role	Builder
Project Contact	Tom Louws
Title	Director
Address	333 Maroondah Highway
City, State or Province, Country	Croydon, Victoria, Australia
Phone	+61 3 9839 6000

Exhibition of School Planning and Architecture

Project Details

Project Name	Officer Secondary College
City	Officer, Melbourne
State	Victoria
District Name	Shire of Cardinia
Supt/President	Michaela Cole (School Principal)
Occupancy Date	January 2015
Grades Housed	7 to 12
Capacity(Students)	1100
Site Size (acres)	12.35 acres
Gross Area (sq. ft.)	35,771 sq.ft
Per Occupant(pupil)	32.5 sq.ft (gross)
Design and Build?	No
If yes, Total Cost:	
Includes:	
If no,	
Site Development:	AUD\$4,054,888
Building Construction:	AUD\$20,652,127
Fixed Equipment:	AUD\$1,050,000
Other:	AUD\$1,363,111
Total:	AUD\$27,120,126

Supporting Images

Specialist Building – Learning Settings Diagram

