

# 2013 Exhibition of School Planning and Architecture

## SunRidge Elementary and Middle School

Winter Garden, Florida



Middle School Entrance

*A K-8 Campus Designed to Feel Like Two Small Schools*



Elementary School Entrance



## Site Planning

The 40-acre K-8 Campus which accommodates more than 2,000 students was designed to uniquely feel like two small schools. By scaling down the size of the schools, it created a comfortable and inviting environment for students with oversized shared components that provide a benefit to the community.

The site was designed to engage with the surrounding community and environment, as well as maximizing the space through a shared bus loop and courtyard that are used by both the elementary school and middle school. The shared courtyard provides opportunities for outdoor learning and collaboration.

The benefits of strategically planning the shared components on the K-8 campus include flexibility, reduced operating costs and efficient use of the District's budget.

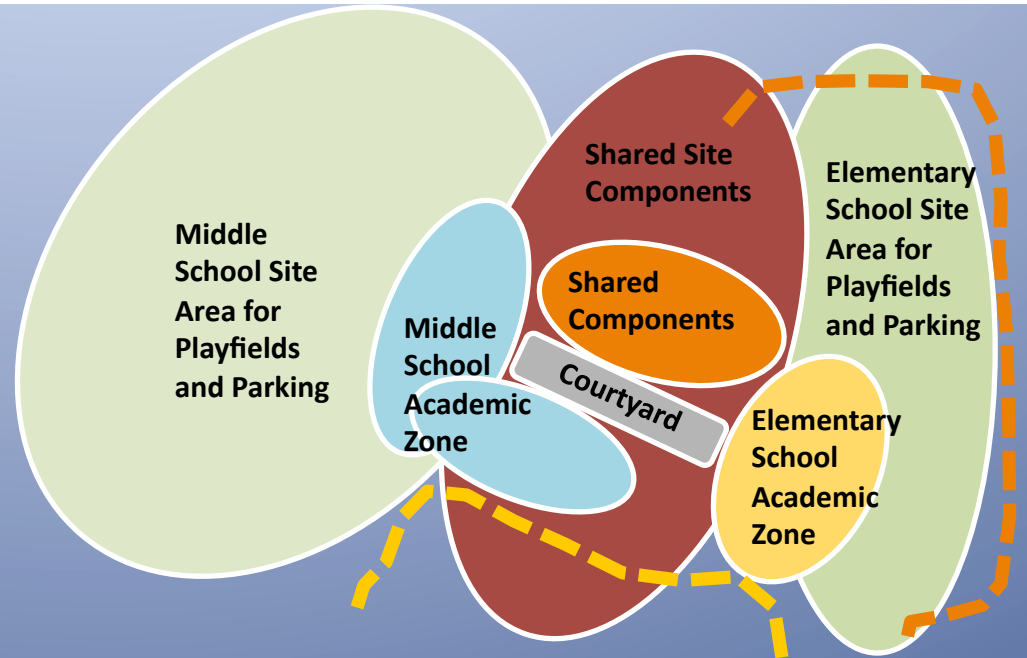

*Shared K-8 Campus Concept Site Plan*



*Shared K-8 Campus Final Site Plan*

## Community Environment:

The K-8 campus serves as both a focal point for the community and a collaborative environment for students, teachers and the community. The design gives each school their own unique identity while providing the community with a place to gather for after-hours events. The K-8 campus creates a community of its own centered on the shared spaces .

*"Our teachers are working together and perhaps opportunities for older students to mentor younger students. We think that will help to make a very nice and seamless transition as students progress through the grades."*  
– Patricia Painter, SunRidge Middle School Principal





In order for each school to function independently, the elementary and middle schools each have their own entrances, academic spaces, administration spaces, and media centers. The shared components include a dining/multi-purpose space, shared central energy plant, courtyard and a bus loop.

The dining/multipurpose space has a shared central kitchen with separate serving lines for the elementary and middle school students. Additionally, the space includes a performing arts stage equipped with operable partitions that allow it to serve as a community venue for assemblies, meetings or school performances.



*Shared Dining / Multi-Purpose with Performing Arts Stage*



*Elementary School Lobby Between Administration and Media Center*



## Learning Environment:

Educationally, the design is based on creating a student centered learning environment with an emphasis on the community nature of the schools. The elementary and middle schools were planned with an academic home philosophy and includes classrooms organized with adjacent lab spaces for interdisciplinary learning.

The elementary school was designed as an L-shape broken down in scale to create 3 distinct neighborhoods each serving 100 students. The elementary school's art and music spaces were designed with cloud ceiling panels, creating a fun and inviting learning environment, while increasing the acoustic properties of each lab.

In order to create a state-of-the-art learning environment, all classrooms were equipped with interactive whiteboards, projectors, and wireless access for laptops and tablets.



*Elementary School Music Suite*



*Middle School CCTV Studio*



*Elementary School Art Lab*



The middle school is one of the School District's few 3-story academic designs utilizing the "School within a School" concept. The school is broken down into smaller schools of 400 students and contains classrooms, labs and teacher workrooms, allowing for the flexibility to organize the floor levels in grades or by academic neighborhoods.

The elementary and middle school each have their own media center to better serve the unique learning characteristics of the elementary and middle school curriculum. The elementary school media center is a more intimate space, with north facing clerestory windows, computer notebook carts and areas set up for group activities, such as story time.

The middle school media center is located on the second floor of the school. This design is based on a 21st century school philosophy and includes flexible, collaborative study zones that allow for large group work, small team work, and multi-media exploration.



*Elementary School Media Center*



*Middle School Collaborative Study Zones*



*Middle School Media Center*



## Physical Environment:

A Florida Traditional architectural style is the vernacular for both schools. This architectural style is very welcoming, timeless and evokes a strong community image. The exterior is constructed with a tilt wall concrete system. Vertical and horizontal clapboard form liners are used to give the building a softer scale and develop a series of patterns to further reduce the scale of this two school complex.

Standing seam metal roofs of natural aluminum on the entry towers create simple way-finding to the front door where the administrations are located. A three color palette of soft pastel colors is used to give the buildings a traditional feel, and further create a human scaled façade.





## Sustainability & Green Design

The K-8 campus embraces the District's green building philosophy, utilizing Green Globes as a benchmark to gauge the design. Green elements incorporated into the school include low VOC products, low E glazing, energy efficient lighting fixtures, water cooled central chiller plant, daylighting in all instructional areas, concrete tilt wall exterior wall system, high reflective roof membrane, and low use water fixtures.



*Sunshades and concrete tilt wall exterior system*

## Planning Process:

The design team worked collaboratively with the community and the School District to create the new K-8 Campus. The design was presented to the public through community meetings at each stage of the design to ensure their needs were met becoming truly a community school.

The team also collaborated with the Owner to ensure that their goals of flexibility and efficiency were incorporated into the design. The planning process also involved a careful analysis of the District's budget to maximize the resources in creating a shared campus for the elementary and middle schools.





## Floor Plan – Conceptual Diagram

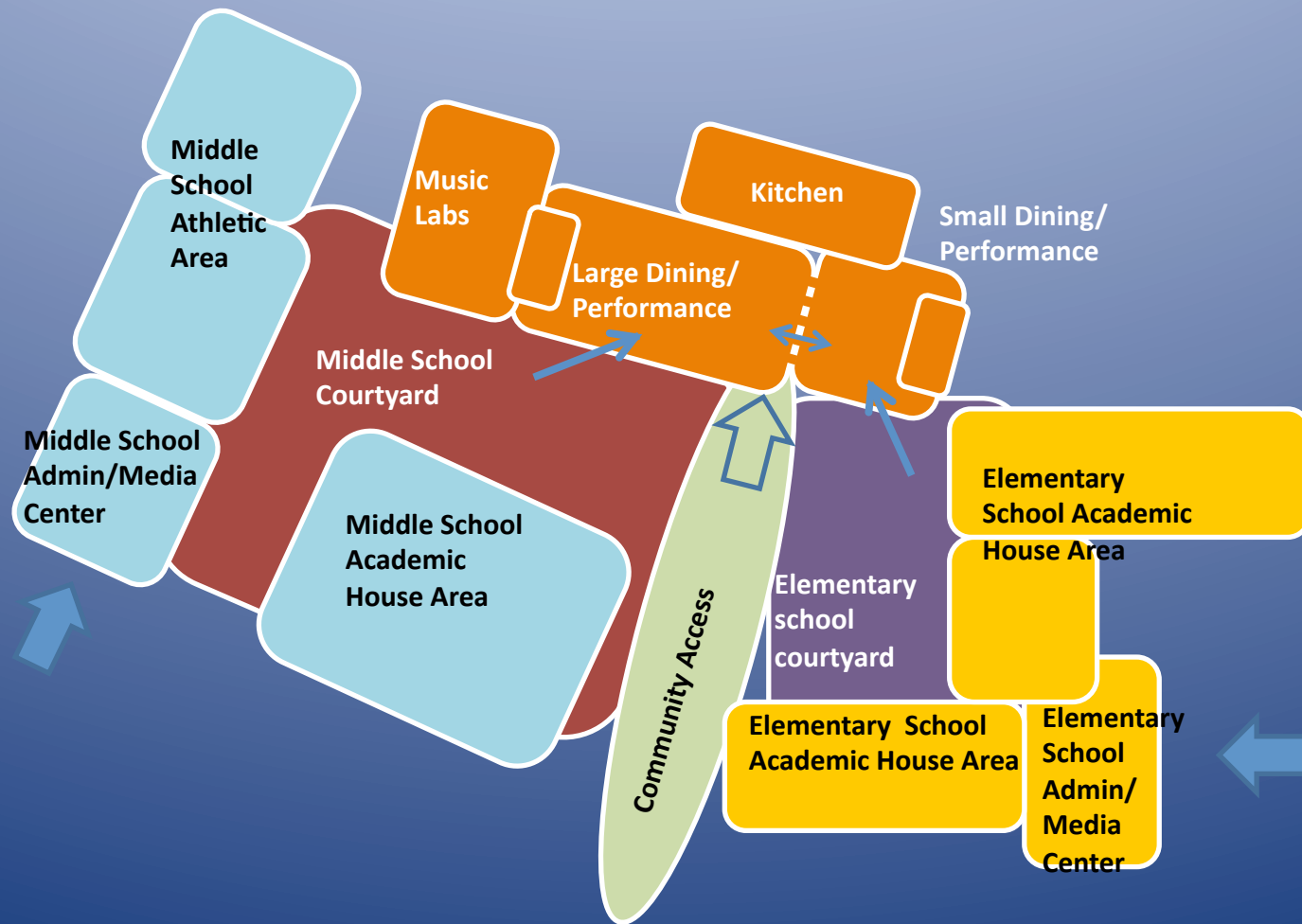

## First Floor Plan

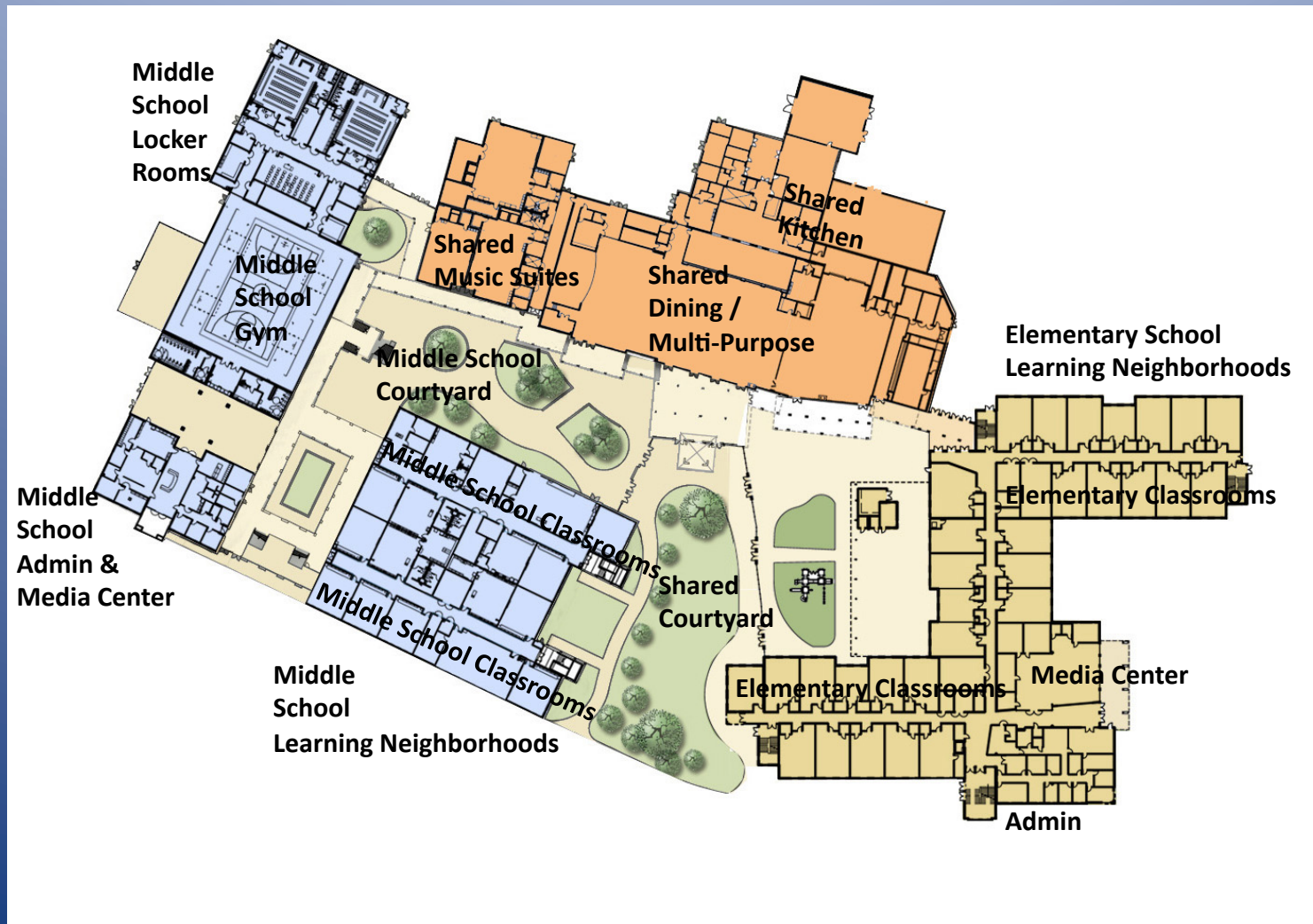



## Second Floor Plan

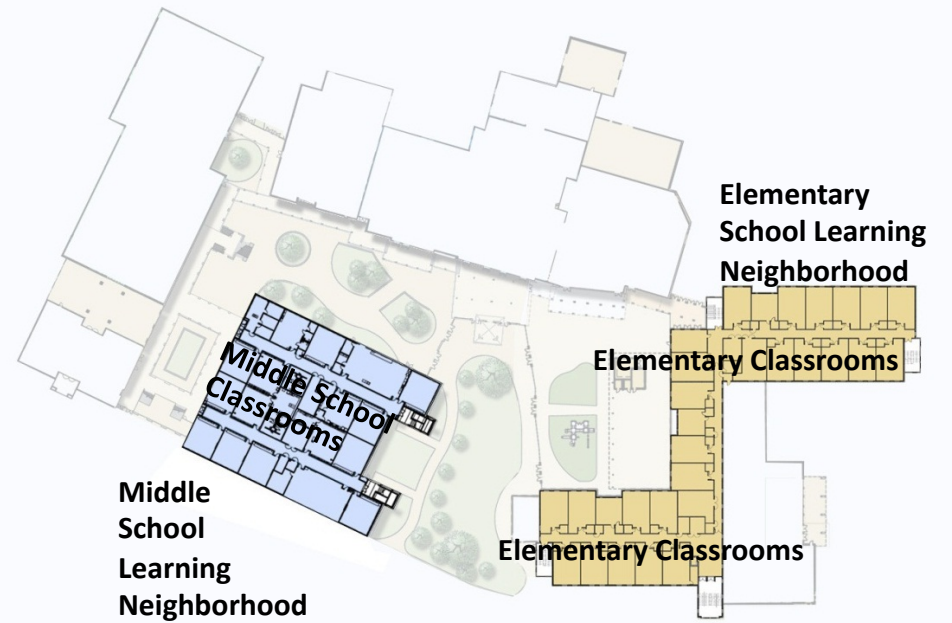

## Third Floor Plan

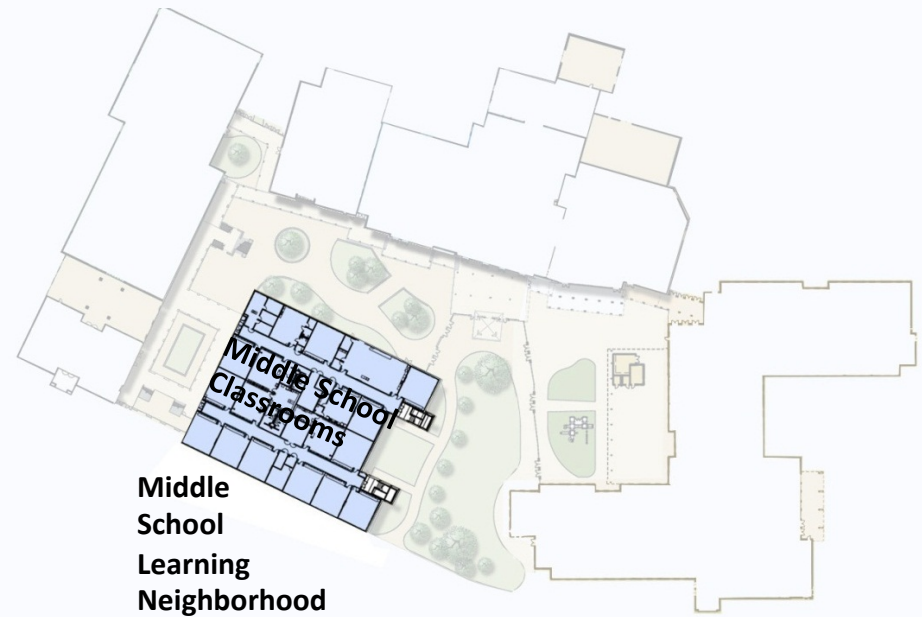

# Exhibition of School Planning and Architecture

## Project Data

Submitting Firm :	SchenkelShultz Architecture
Project Role	Architect
Project Contact	Daniel M. Tarczynski, AIA
Title	Partner
Address	200 E. Robinson Street, Suite 300
City, State or Province, Country	Orlando, FL USA
Phone	407-872-3322
Joint Partner Firm:	N/A
Project Role	
Project Contact	
Title	
Address	
City, State or Province, Country	
Phone	
Other Firm:	
Project Role	
Project Contact	
Title	
Address	
City, State or Province, Country	
Phone	
Construction Firm:	Pirtle Construction Company
Project Role	Construction Manager
Project Contact	Mike Geary
Title	Vice President
Address	5700 Griffin Road, Suite 200
City, State or Province, Country	Davie, FL USA
Phone	954-797-0410



# Exhibition of School Planning and Architecture

## Project Details

Project Name	SunRidge Elementary and Middle School
City	Winter Garden
State	Florida
District Name	Orange County Public Schools
Supt/President	Barbara M. Jenkins
Occupancy Date	August 2012
Grades Housed	K-8 grades
Capacity(Students)	ES: 838 / MS: 1,215
Site Size (acres)	approx. 40 acres
Gross Area (sq. ft.)	ES: 89,289 SF / MS: 171,674 SF
Per Occupant(pupil)	ES: 106 / MS: 141
gross/net please indicate	Net
Design and Build?	N/A
If yes, Total Cost:	
Includes:	
If no,	
Site Development:	\$162,802
Building Construction:	\$37,202,522
Fixed Equipment:	Held by client
Other:	
Total:	\$37,365,324