

2013 Exhibition of School Planning and Architecture

RED HAWK ELEMENTARY SCHOOL

Erie, Colorado

RED HAWK ELEMENTARY SCHOOL



RED HAWK ELEMENTARY SCHOOL

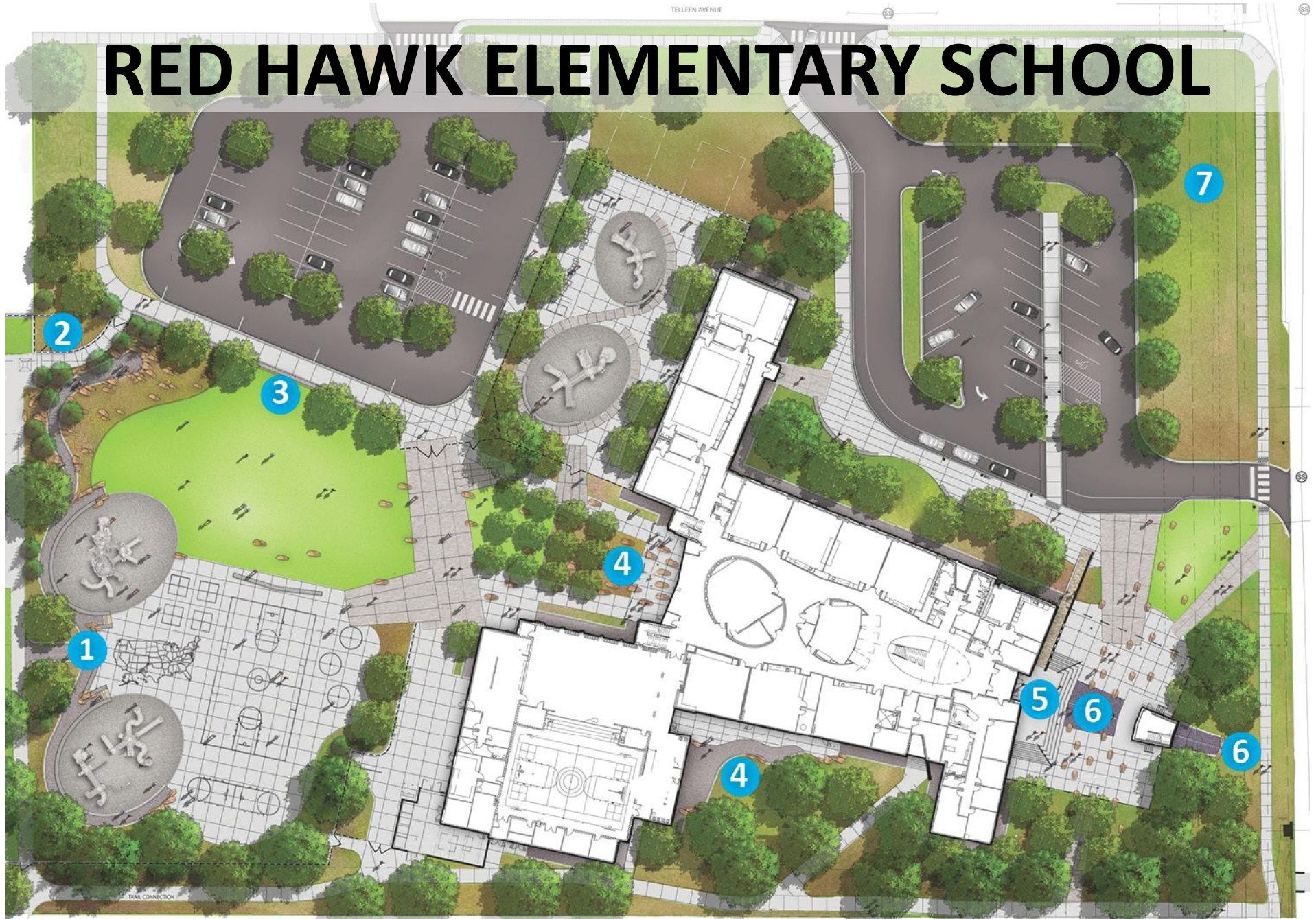

1. PLAINS-TO-PEAKS ECO TRAIL
2. COMMUNITY GARDEN

3. INTERPRETIVE WALL
4. OUTDOOR CLASSROOM

5. OUTDOOR STAGE
6. RAIN FEATURE

7. BIOSWALE

0' 20' 40' 80'

NORTH



COMMUNITY: NEIGHBORHOOD SCHOOL

Red Hawk is located in the heart of the growing town of Erie. It is fed primarily by children from the surrounding developments to the Northeast, South, and West.

A community path runs underneath the covered entrance of the school, encouraging parents to walk or bike with their children each morning.

The building is sited to the South, close to the street. Therefore, the entryway at Red Hawk is very visible, and the lively mix of parents and children becomes a focal point for the community.

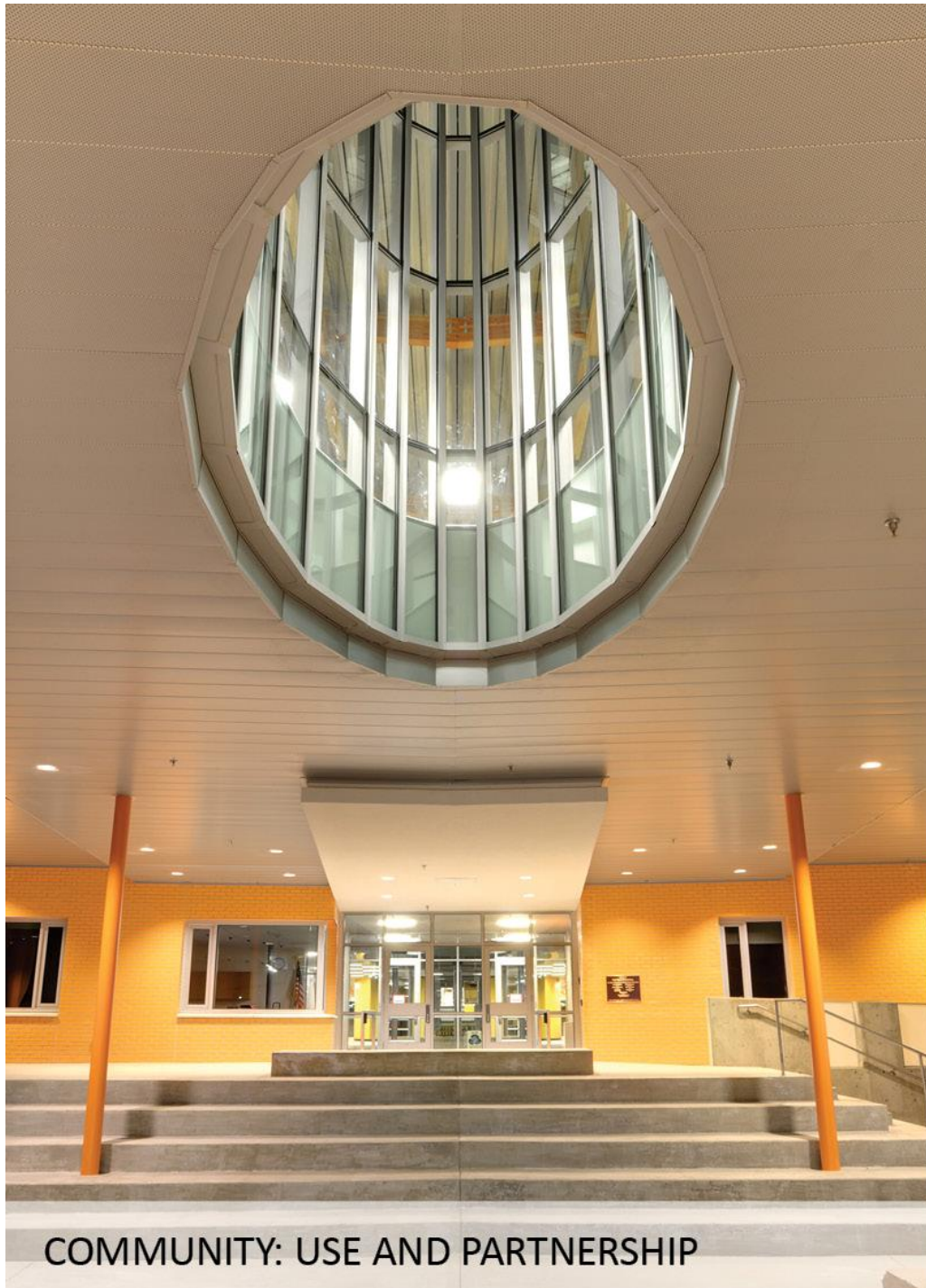

COMMUNITY: USE AND PARTNERSHIP

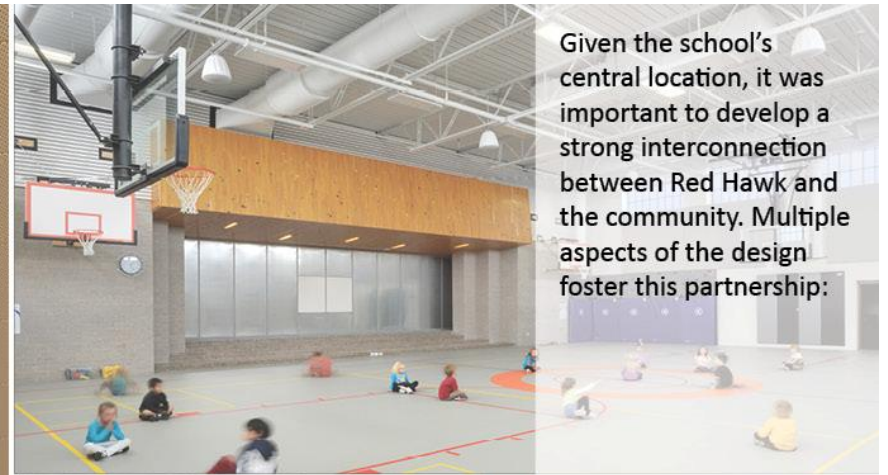

Given the school's central location, it was important to develop a strong interconnection between Red Hawk and the community. Multiple aspects of the design foster this partnership:

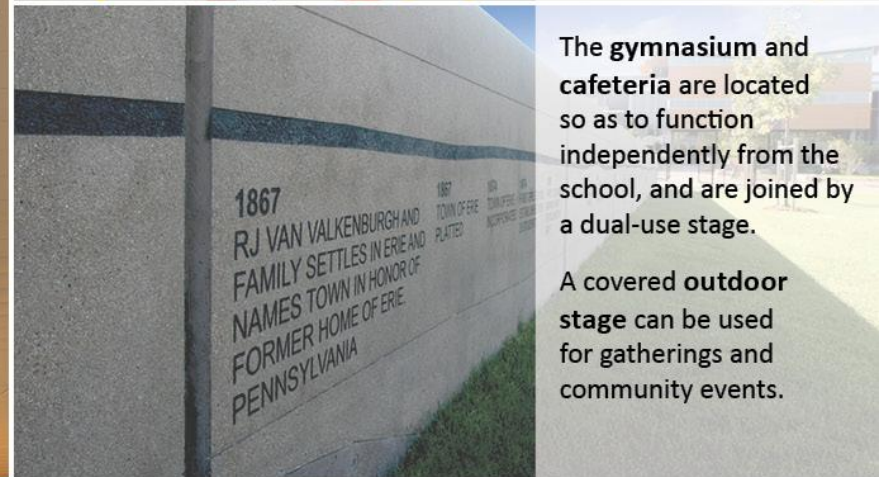

The gymnasium and cafeteria are located so as to function independently from the school, and are joined by a dual-use stage.

A covered outdoor stage can be used for gatherings and community events.



Outdoor areas are used as both **Community gardens** and teaching spaces.

Various site features, including a **regional history wall**, and **outdoor classrooms** encourage community interaction with the building and site.

LEARNING: MOVEMENT



Red Hawk's commitment to physical activity and student health is truly exceptional. Their All-School Movement Program is designed to get students out of their seats for 40 minutes every day, in addition to PE and recess.

In-class movement sessions are partnered with school-wide events to empower students to be active and healthy. One of the most popular is the 'Red Hawk Walk', in which students power-walk through the wide hallways, flex spaces, and community areas of the buildings alongside their teachers and school staff. This increased exercise helps students stimulate their brains prior to their most rigorous academic subjects, and facilitates learning.

In fact, the All-School Movement Program has been so successful that recently Red Hawk was recognized with a national award through the Active Schools Acceleration Project.

LEARNING: ANYTIME, ANYWHERE

Early in the design of Red Hawk the primary consideration was to eliminate traditional school hallways, allowing for the insertion of unique and creative learning environments.

Breakout areas are located adjacent to classrooms, allowing for one-on-one time.

Highly visible **flex spaces** throughout the school allow for interaction between grades.

The **Mineral Garden**, found in the main corridor, is composed of regional rocks and minerals, and is open to student exploration.

A glass **Weather Funnel** allows students to experience outdoor conditions like cloud cover and precipitation throughout the day.

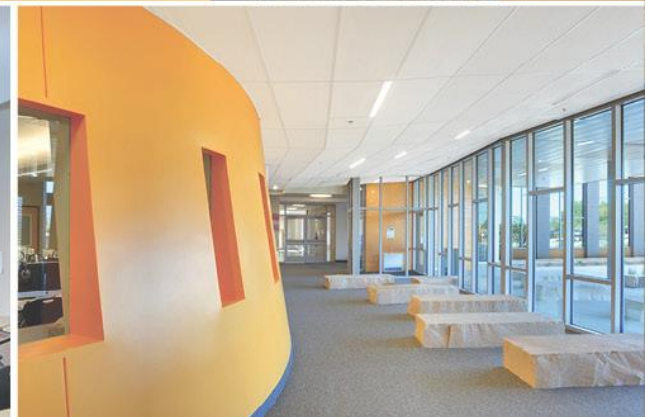

PHYSICAL ENVIRONMENT: STREET FESTIVAL DESIGN

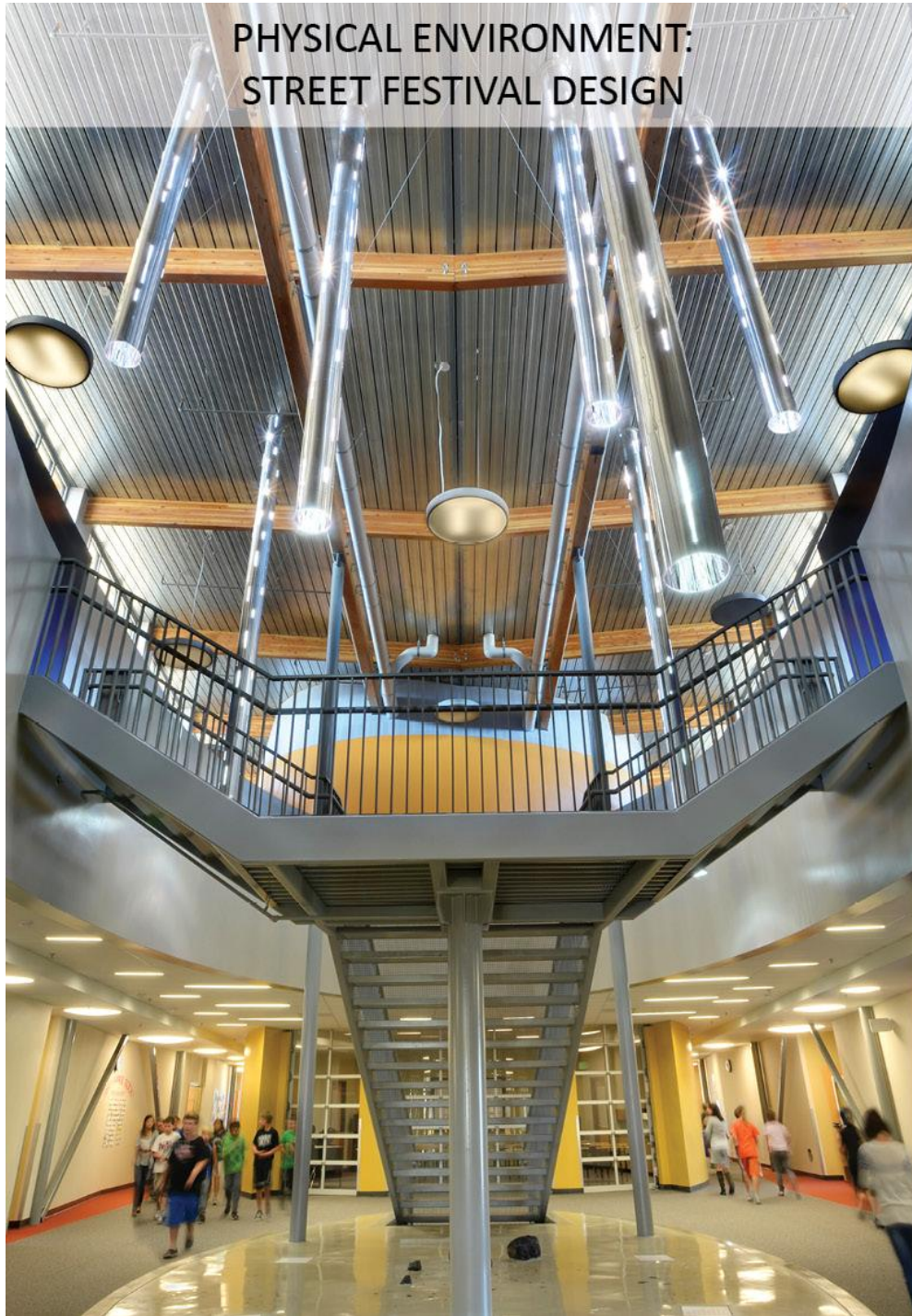

For inspiration, the design team studied scenes of street festivals in urban areas. During these festivals, multiple pavilions of different colors and shapes are set up in central spaces, framed by buildings on each side. The most important part of this experience is movement. The ability to weave in and out and around this colorful setting is a joyful experience that is relived in the common 'living room' at the center of the Red Hawk design.

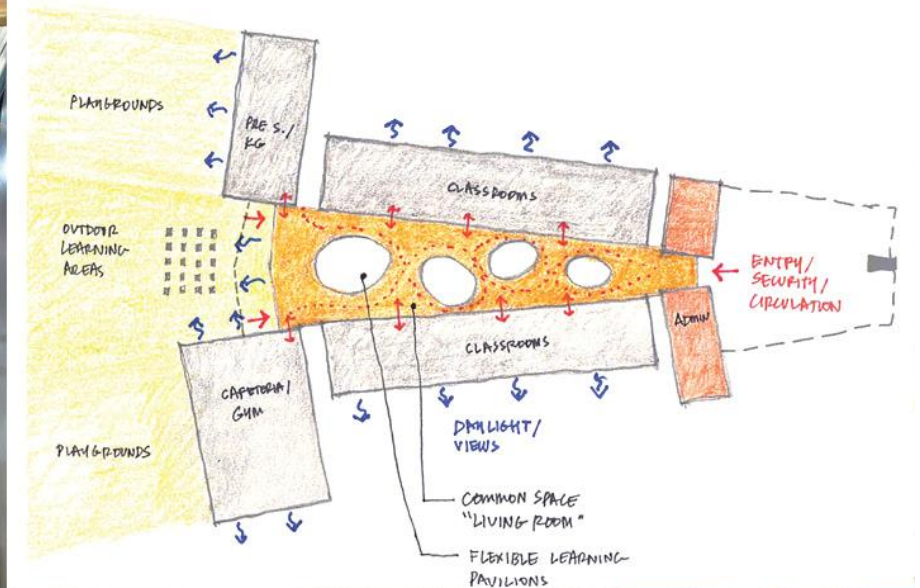



PHYSICAL ENVIRONMENT: SUSTAINABILITY

Red Hawk is designed to meet a variety of sustainability goals- from energy use to indoor environment quality. As much as possible, passive design elements are used to promote occupant health and better student learning. Some of the key sustainable features include:

Classroom, community space, and circulation daylighting design as well as **views outside**. This keeps occupants connected to the outdoors and encourages proper circadian rhythm.

Displacement ventilation delivers air from **ground source heat pumps**. This keeps room temperatures consistent and is much quieter than a conventional system.

The specification of **low-emitting materials**, so as to minimize occupant exposure to harmful chemicals such as VOC's.

Red Hawk achieved **LEED Gold**.

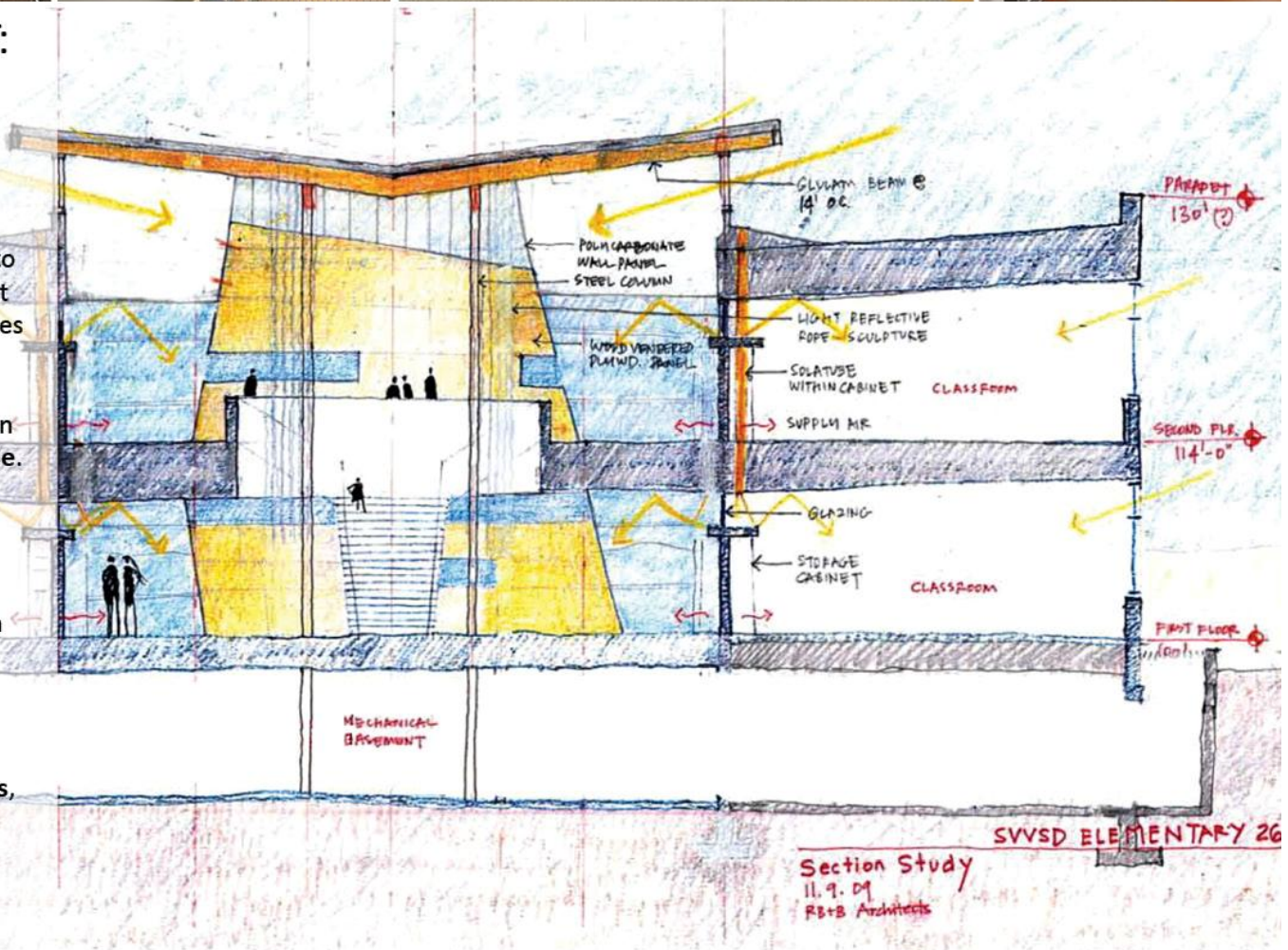



PLANNING: BRINGING THE COMMUNITY TOGETHER

During the planning process, it was very important for the design team to work closely with the community to understand their goals, and bring their new school to life.

For this reason, important events in the planning, design, and construction process were considered chances to bring the community together. These moments include:

- DAG meetings early in design composed of community members, the design team, and future school staff.
- A community meeting, set as a design fair, to introduce the various aspects of the design in an interactive setting.
- A community groundbreaking celebration (seen above).

PLANNING: MAJOR EVENTS

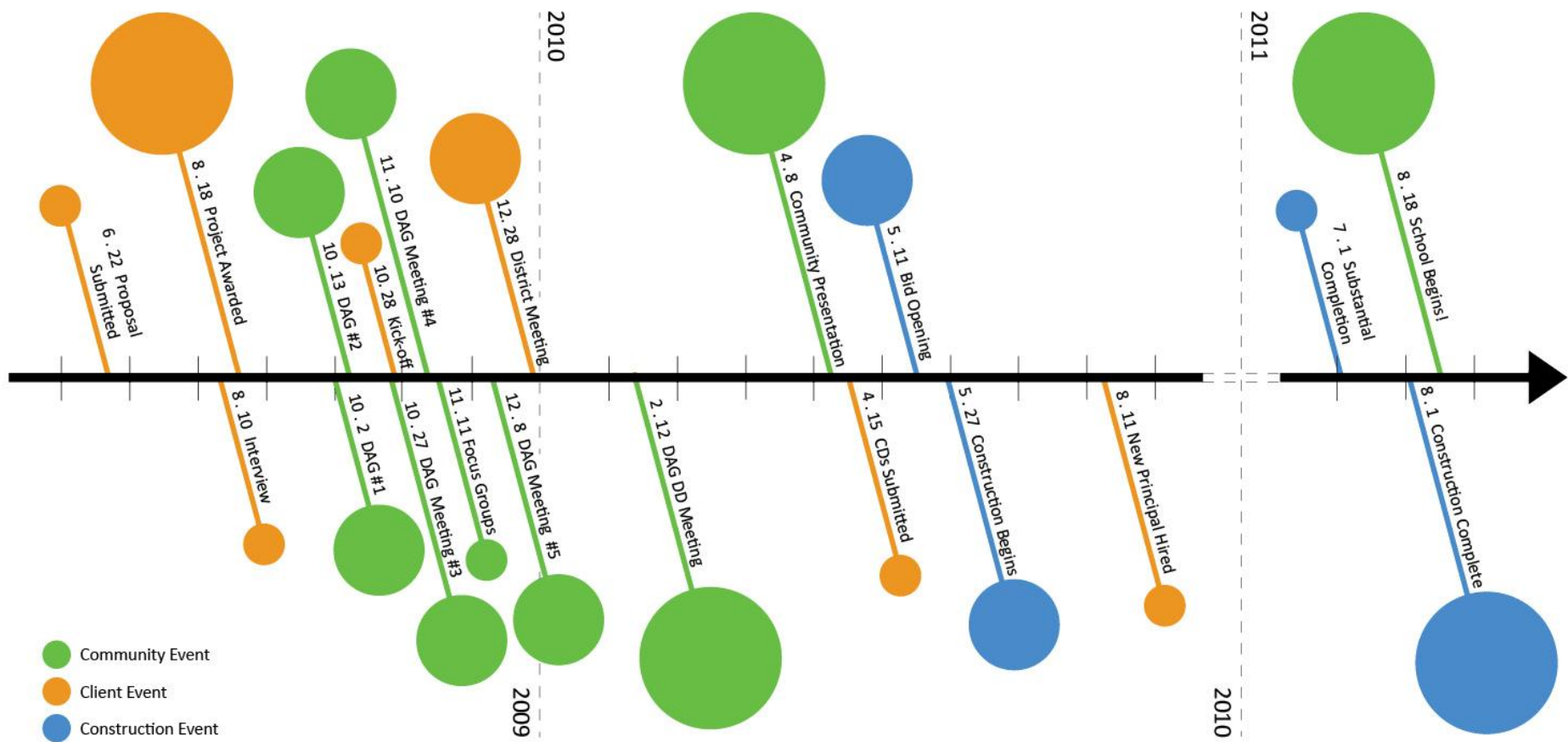



- 1. GYMNASIUM
- 2. CAFETERIA
- 3. CLASSROOMS
- 4. COMPUTER SPACES
- 5. FLEX ROOMS
- 6. MUSIC ROOM
- 7. ART ROOM
- 8. SPECIAL EDUCATION
- 9. MINERAL GARDEN
- 10. ADMINISTRATION
- 11. WEATHER FUNNEL
- 12. STAGE

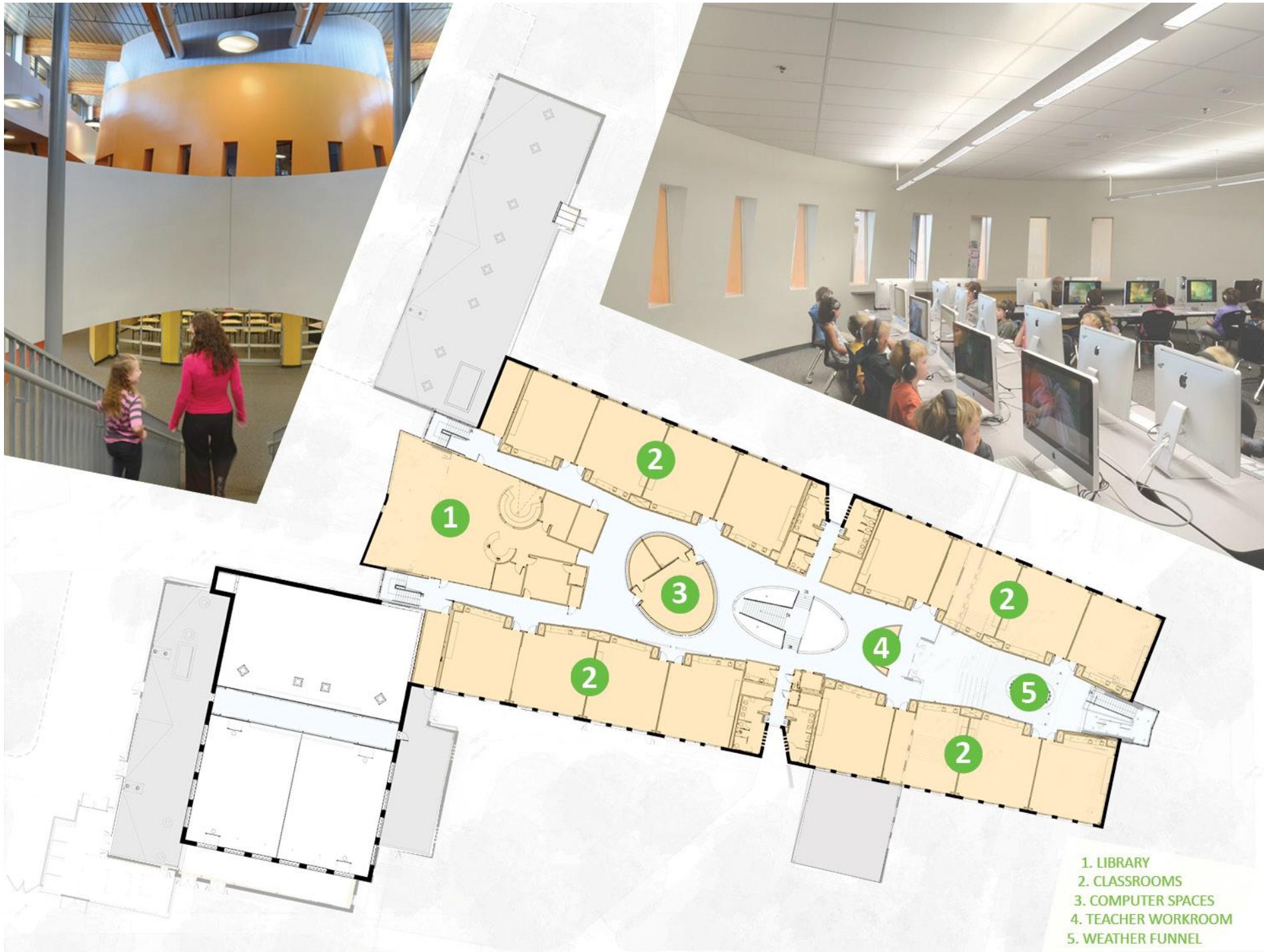
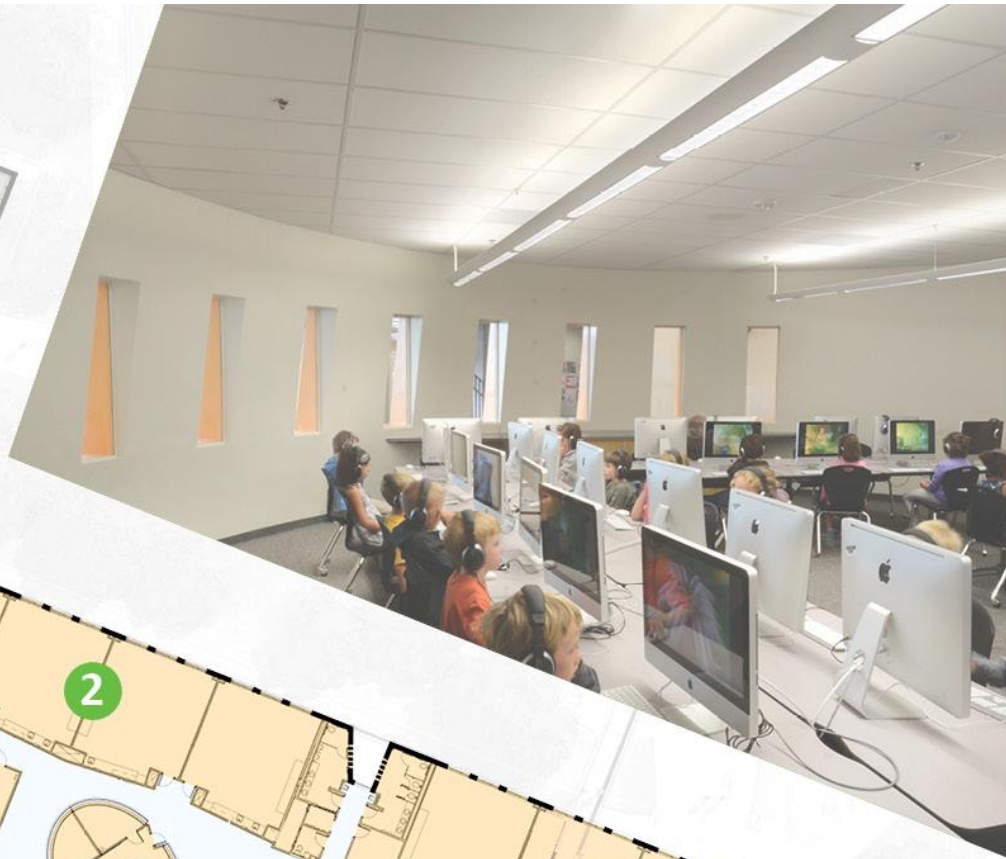

- 1. LIBRARY
- 2. CLASSROOMS
- 3. COMPUTER SPACES
- 4. TEACHER WORKROOM
- 5. WEATHER FUNNEL

Exhibition of School Planning and Architecture

Project Data

Submitting Firm :	RB+B Architects
Project Role	Architect
Project Contact	Corky Bradley
Title	Principle
Address	315 E. Mountain Ave, #100
City, State or Province, Country	Fort Collins, Colorado, United States
Phone	970-484-0117

Joint Partner Firm:	
Project Role	
Project Contact	
Title	
Address	
City, State or Province, Country	
Phone	

Other Firm:	
Project Role	
Project Contact	
Title	
Address	
City, State or Province, Country	
Phone	

Construction Firm:	Adolfson & Peterson
Project Role	Contractor
Project Contact	Dan Lamphere
Title	
Address	797 Ventura Street
City, State or Province, Country	Aurora, Colorado, United States
Phone	303-363-7101

Exhibition of School Planning and Architecture

Project Details

Project Name	Red Hawk Elementary School
City	Erie
State	Colorado
District Name	St. Vrain School District
Supt/President	
Occupancy Date	8-1-2011
Grades Housed	P-5
Capacity(Students)	600+
Site Size (acres)	12.6
Gross Area (sq. ft.)	71,157
Per Occupant(pupil)	118.6
gross/net please indicate	1.32
Design and Build?	No
If yes, Total Cost:	
Includes:	
If no,	
Site Development:	\$1, 287, 606
Building Construction:	\$10,004,442
Fixed Equipment:	\$259,939
Other:	
Total:	\$11,551,987



EAST ENTRY AT DUSK

During the day, the covered east entry provides a gathering place for student. At night, it becomes a focal point for community events.

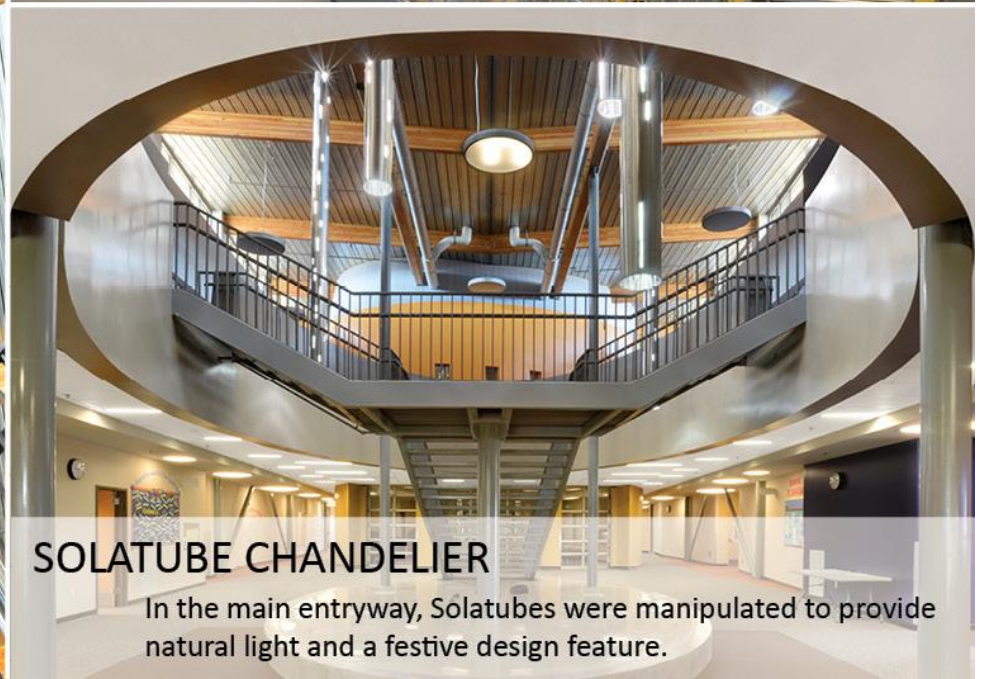
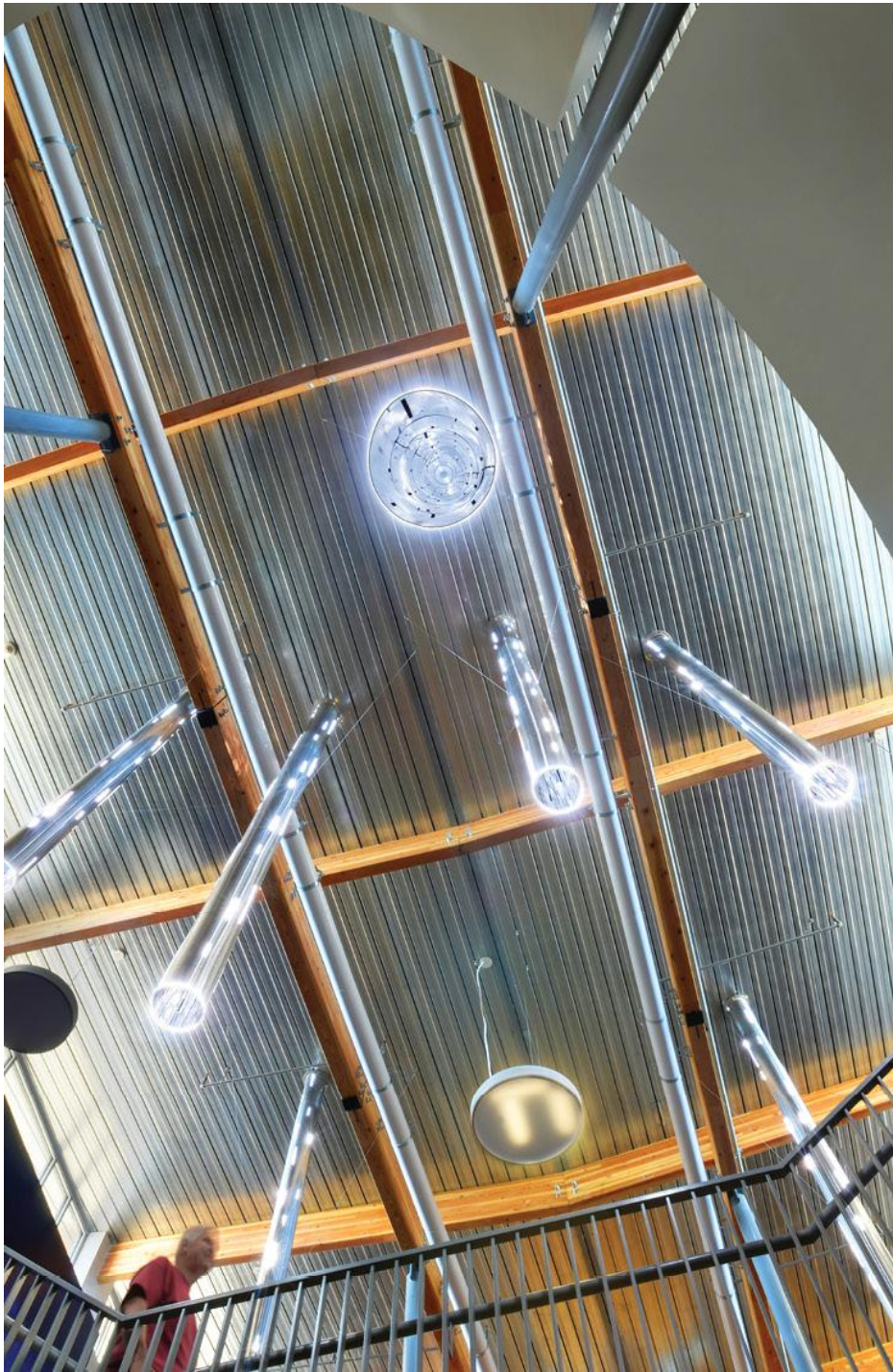

SOLATUBE CHANDELIER

In the main entryway, Solatubes were manipulated to provide natural light and a festive design feature.



OUTDOOR STAGE

The outdoor stage is located directly under the weather tunnel. It allows a view from the inside out, and outside in, keeping students connected during the day, and is also an ideal location for school assemblies and events.

Materials

Red Hawk combines a variety of materials and textures, including brick, glazed brick, metal panel, ground face CMU, cementitious wall panels, exposed concrete, wood, and glass. This variety gives students a chance to interact with and learn directly from the building.



