

2013 Exhibition of School Planning and Architecture

Central Intermediate School

Ottawa, Illinois

Central Intermediate School



Central Intermediate School

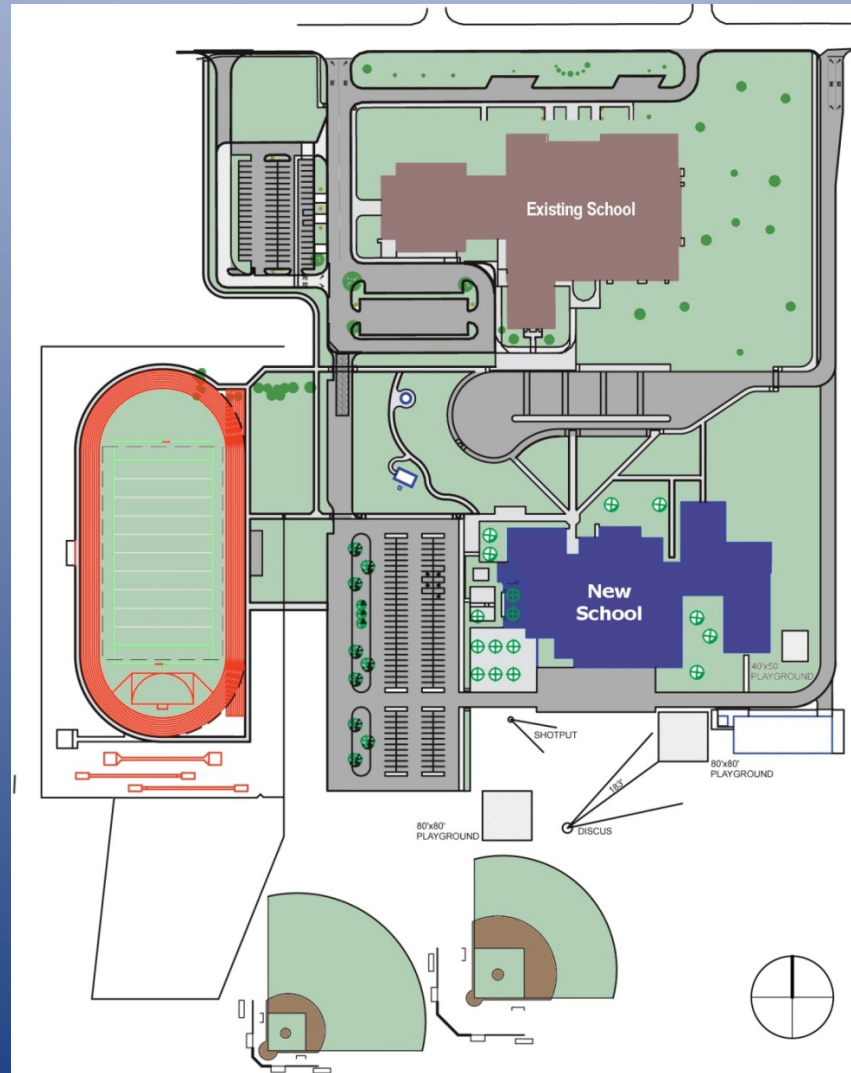

Flood and Recovery

Community Environment: In September 2008, the Illinois River flooded near Ottawa, Illinois and inundated the town's Central Intermediate School. When cleanup efforts proved it would be months – if ever – before the school could be used again, the district involved their architects to help find alternate learning spaces for 450 displaced 5th and 6th graders.

Working closely with the community, 5th grade classes were relocated to a church's educational facility and 6th graders were housed – first in the gymnasium and later in mobile classrooms – at the district's middle school. Throughout the ordeal, students missed only two days of classes and were back in dedicated learning spaces in less than a month.



Many Voices, Many Hands

Community Environment: *Continued...*

Discussions were held with the State of Illinois' School Board of Education (ISBE) and Capital Development Board (CDB) as well as with the Federal Emergency Management Agency (FEMA) to determine the fate of the flooded school. Monies were found that helped defray the cost of relocating students to new temporary facilities.

After lengthy discussion between the above agencies, the District's architect, the Illinois Emergency Management Agency (IEMA), the City of Ottawa, and the District's insurance company, it was determined the old building was an economic loss.



Respite, Forging Ahead

Community Environment: *Continued...*

The search began for interim classroom space as well as a new building site. A local department store, shuttered two years prior, was selected as a medium term housing solution for the fifth and sixth graders. Using leased office furniture and equipment to transform the former big box store, a new classroom facility was created.

Work also began on planning and building a new school. An optimal site, located adjacent to the middle school was acquired by the District. Following a successful referendum in February 2010, ground was broken for the new 97,000 SF Central Intermediate School in September the same year. The project proceeded smoothly and was completed on schedule in December 2011.

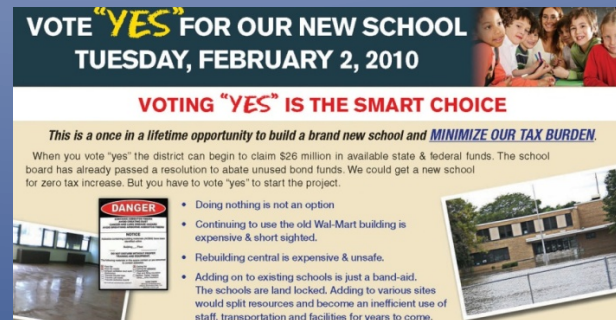
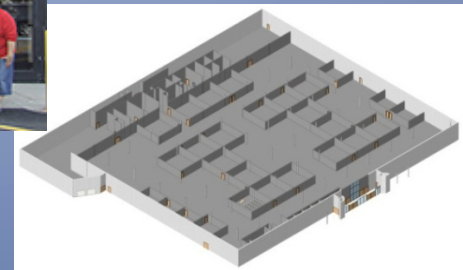

Library, Computers and Performance

The new school is a testament to the resilience of its community. It features a 2-story 20-classroom wing that includes 2 computer labs along with a special education Life Skills lab. A library/media center and instructional technology lab support learning spaces while fine arts has its own dedicated room complete with kiln.



Library, Computers and Performance

Learning Environment:

The district has a vibrant and renowned performing arts program. To support the program, dedicated band and chorus rooms, complete with practice spaces, were made part of the new building.



Additional support for the program is provided by a dual purpose Cafetorium. The Cafetorium is acoustically tuned and features university level sound and lighting equipment as well as remote video projection. Its stage looks out on available seating for 650 program/event attendees.



Cafetorium, Gymnasium

Learning Environment: *Continued...*

This same stage can also open on to a 2-station competition gym with bleacher seating for 600. This adds flexibility to how the Cafetorium and Gym are used and allows for district-wide gatherings and events.

The Learning Center and Cafetorium spaces make creative use of a canted store front system to add visual interest to the building's exterior as well as optimize views from within the school.



Durable, Pleasing, Sustainable

Physical Environment

Hallways and common areas have terrazzo flooring. Interior walls are ground face block in high traffic areas. They are tied visually to exterior walls through the common use of cast concrete stone accents. Green vegetated roofs cover portions of the school.



21st Century Environment

Physical Environment – *Continued...*

All classrooms feature interactive teaching technology. In addition, each is connected to the school's automated energy management system and makes use of daylight harvesting techniques. The school has been awarded LEED Silver certification, a stated goal of the school district. Aesthetically, the school captures the nuance of its site and aspirations of its community.



Looking Southeast, Southwest, and Ahead

Planning Process:

Because the new school was a result of a catastrophic event, many outside funding agencies had a part in its planning. In addition to the architect and school district, the insurance company, the local municipality, the county, the state, and the Federal government all had a voice in where the building would be located, how large it would be, what grades it would serve, what sustainable design goals it would achieve, and what its probable cost would be.

The new Central Intermediate School makes a strong functional statement through its use of durable material, advanced building systems, and accommodating layout. The school is programmatically flexible and will support the district's curriculum for years to come.



Floor plan



First Floor Plan



Floor plan



Second Floor Plan

Exhibition of School Planning and Architecture

Project Data

Submitting Firm :	GreenAssociates, Inc.
Project Role	Architect
Project Contact	George W. Reigle, AIA
Title	Principal
Address	111 Deerlake Road, Suite 135
City, State or Province, Country	Deerfield, Illinois 60015 USA
Phone	847-317-0852

Joint Partner Firm:	
Project Role	
Project Contact	
Title	
Address	
City, State or Province, Country	
Phone	

Other Firm:	
Project Role	
Project Contact	
Title	
Address	
City, State or Province, Country	
Phone	

Construction Firm:	GreenAssociates, Inc.
Project Role	Construction Manager
Project Contact	Gerald L. Guy, PE
Title	Director of Construction Services
Address	111 Deerlake Road, Suite 135
City, State or Province, Country	Deerfield, Illinois 60015 USA
Phone	847-317-0852

Exhibition of School Planning and Architecture

Project Details

Project Name	Central Intermediate School
City	Ottawa
State	Illinois
District Name	Ottawa Elementary School District 141
Supt/President	Mr. Cleve Threadgill
Occupancy Date	December 2011
Grades Housed	Fifth and Sixth Grades
Capacity(Students)	450 Students
Site Size (acres)	26 Acres
Gross Area (sq. ft.)	97,614
Per Occupant(pupil)	217 SF/Pupil
gross/net please indicate	69.5%
Design and Build?	No
If yes, Total Cost:	NA
Includes:	NA
If no,	
Site Development:	\$900,275
Building Construction:	\$18,966,539
Fixed Equipment:	\$3,110,039
Other:	NA
Total:	\$22,976,853