

2015 Exhibition of School Planning and Architecture

Charles R. Drew Charter School Junior & Senior Academy

Category: New Construction

Atlanta Public Schools

Atlanta, Georgia

Charles R. Drew Charter School Junior & Senior Academy



Charles R. Drew Charter School Junior & Senior Academy



Front Entrance

Community Environment

Located on the back nine of the public golf course adjacent to the East Lake Villages and the East Lake Golf Club, the school is built for 400 middle school students (6th-8th grades) and 600 high school students (9th-12th grades). Set on one of the highest points in Atlanta, the 4-story, 200,000 SF Drew Charter School was situated to be a visible centerpiece of the East Lake community. Founded in 1890, East Lake is one of Atlanta's most historic neighborhoods. In recent years East Lake has enjoyed a rebirth due in part to The East Lake Foundation. East Lake is a great example of community redevelopment with a mission to break the poverty cycle for many of it's residents.

Fifteen years ago, East Lake Meadows, a public housing project with 1,400 residents was a terrifying place to live. Nine out of 10 residents had been a victim of a crime. Today it is a safe community of working, taxpaying families whose children excel in the classroom.



Westview of Exterior

Community Environment

In the mid 1990's Tom Cousins, an Atlanta real estate developer and philanthropist, working with the mayor and the Atlanta Housing Authority, spearheaded an effort to totally rebuild the East Lake Meadows neighborhood with low and middle income housing and to rebuild the neighborhood school, Drew Elementary. At the time, Drew was the worst performing school in the city.

In 2000, after negotiating with Atlanta Public Schools to secure the city's first public charter school, Charles E. Drew School reopened in the rebuilt East Lake Villages as a K-8th grade facility. Drew offered longer school days and an extended school year. While serving 90% of the children in the East Lake neighborhood, within a few short years, this school became the 4th best performing school in the city.



Project Lab

Learning Environment

The project lab, a large flexible space outfitted entirely with mobile furniture, wireless networking, both mobile and fixed technology presentation capabilities, floor mounted power, sinks and storage cabinets, and utilities such as water and power, is intended to provide a completely flexible environment that is student-centered.

These labs are distributed throughout the school with each grade level having access to their own lab, and they provide the building block for the educational process. These state of the art spaces are intended to provide a completely flexible environment that is student centered and enhances experiential learning.



Classroom

Learning Environment

The Academy has taken an innovative stance on technology and its implementation. It is a 1 to 1 school with fixed and mobile flat screens located throughout the building. Because project based learning is based on three core steps – inquire, make and share, integrating technology to enable these activities was a key design criteria for the success of the school.

Mobile flat panel displays are located in the project labs and teacher planning areas. Large format projection capabilities are located in labs, classrooms and public areas. And fixed interactive flat panel displays are in every direct instruction space as well as in the lobby areas.



North Plaza

Physical Environment

The new Junior and Senior Academy is located on 39 acres directly adjacent to the existing Drew Charter Elementary Academy campus. The new campus represents a broad range of spaces for community, educational, and athletic programs. The South Patio offers outdoor dining areas for the cafeteria as well as space for the robotics lab, band, and choral programs.

The North Plaza connects the academic building to the gymnasium and auditorium and provides a dynamic setting for outdoor learning.



Art Garden

Physical Environment

The Art Garden is an open space adjacent to the auditorium and showcases the building's rainwater collection design and sustainable landscaping. This multipurpose space can serve as the outdoor pre-function area for performances, location for weekend green markets, and a host of other school and community events.



Community Workshops

Planning Process

The design process began with a series of workshops that engaged some 60 stakeholders including representatives from the East Lake Villages, the adjoining East Lake YMCA, the East Lake Foundation, the Cousins family, and the existing Drew Charter School. Participants in the workshops from the school included Board members, parents, administrators, staff, teachers, and a number of elementary and middle school students.

Getting the constituent community buy-in on the value of experiential learning helped the administration in its implementation of the Project Based Learning (PBL) curriculum and in getting the faculty and staff thinking about new ways to use space.



Collaborative Classroom

Planning Process

Consensus grew around the importance of collaboration for both students and faculty; how important teamwork and the exchange of ideas are for an enriched learning experience. This desire to be able to foster collaboration for everyone became a major driver in the design.



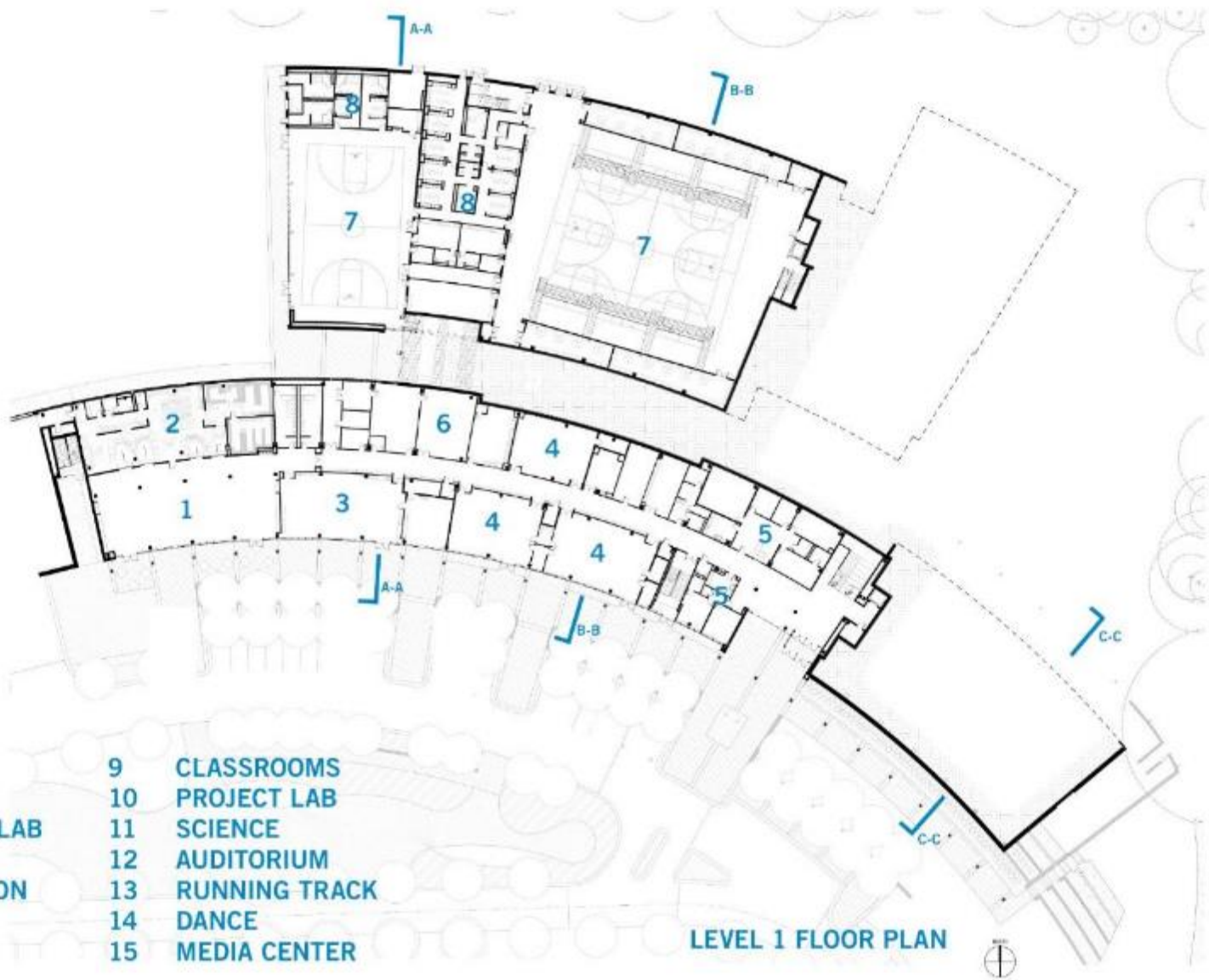

LEGEND

- | | |
|-------------------|------------------|
| 1 CAFETERIA | 9 CLASSROOMS |
| 2 KITCHEN | 10 PROJECT LAB |
| 3 CAREER TECH LAB | 11 SCIENCE |
| 4 MUSIC | 12 AUDITORIUM |
| 5 ADMINISTRATION | 13 RUNNING TRACK |
| 6 SERVICE | 14 DANCE |
| 7 GYMNASIUM | 15 MEDIA CENTER |
| 8 LOCKERS | |

LEVEL 1 FLOOR PLAN

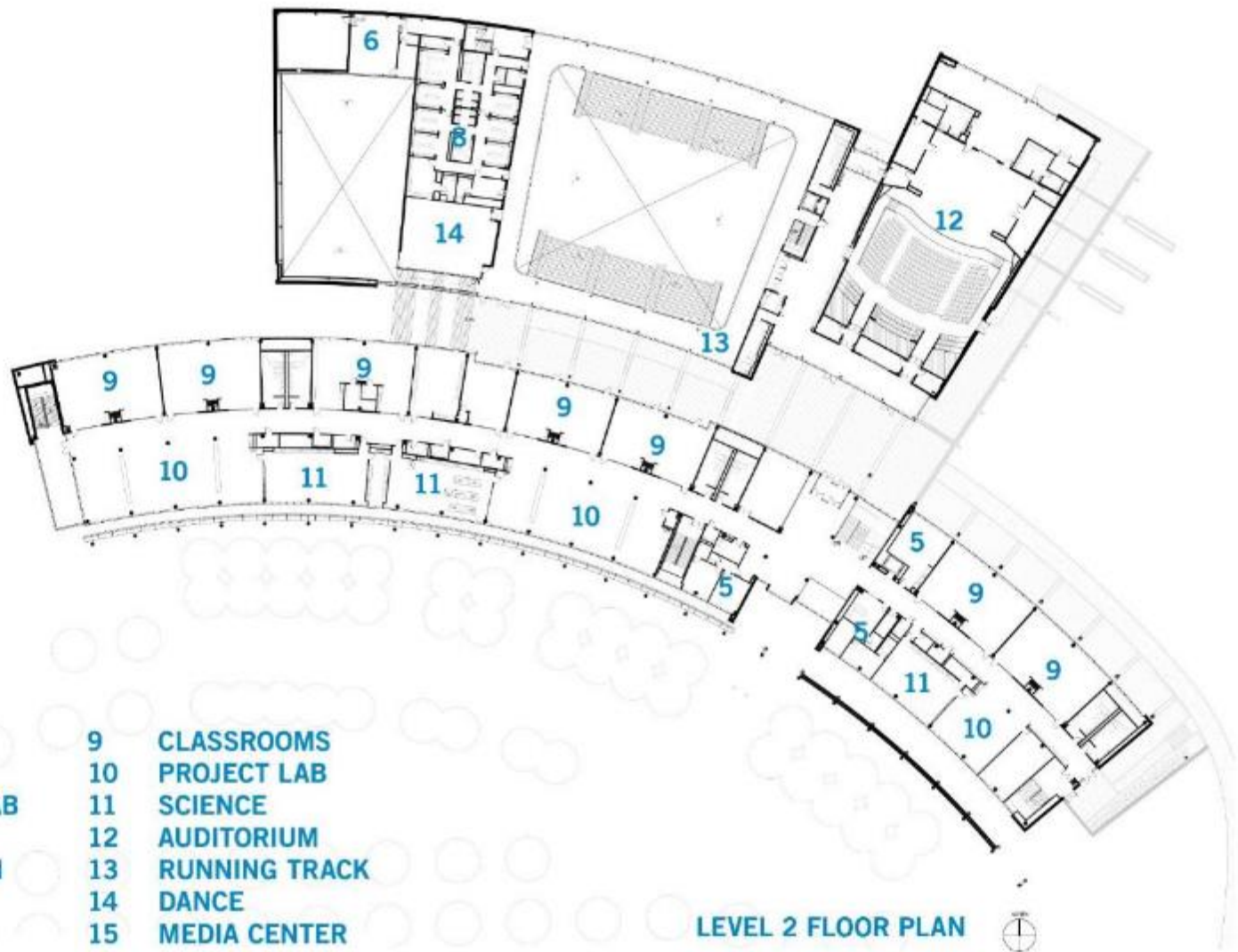

LEGEND

- | | |
|-------------------|------------------|
| 1 CAFETERIA | 9 CLASSROOMS |
| 2 KITCHEN | 10 PROJECT LAB |
| 3 CAREER TECH LAB | 11 SCIENCE |
| 4 MUSIC | 12 AUDITORIUM |
| 5 ADMINISTRATION | 13 RUNNING TRACK |
| 6 SERVICE | 14 DANCE |
| 7 GYMNASIUM | 15 MEDIA CENTER |
| 8 LOCKERS | |

LEVEL 2 FLOOR PLAN

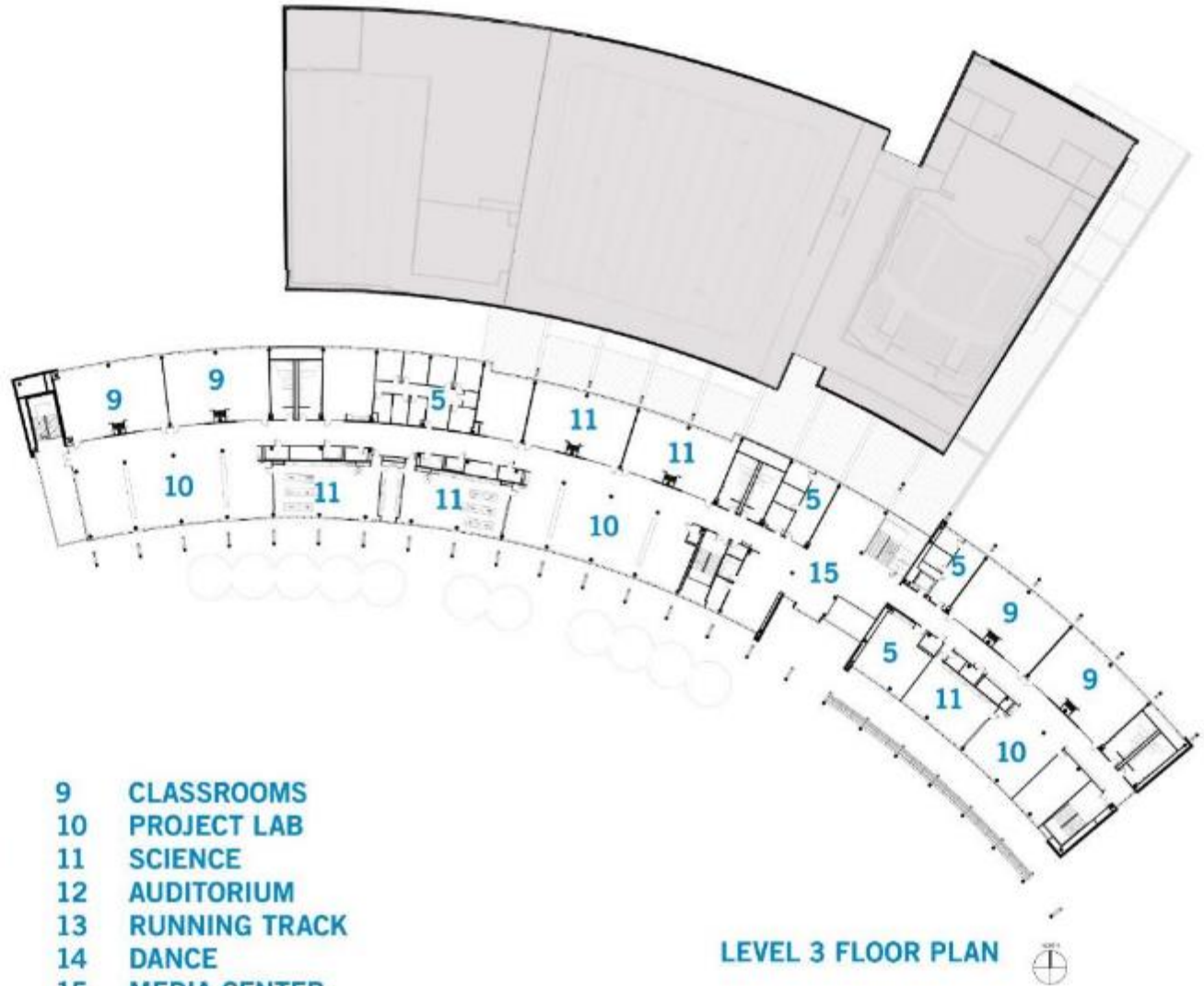

LEGEND

- | | |
|-------------------|------------------|
| 1 CAFETERIA | 9 CLASSROOMS |
| 2 KITCHEN | 10 PROJECT LAB |
| 3 CAREER TECH LAB | 11 SCIENCE |
| 4 MUSIC | 12 AUDITORIUM |
| 5 ADMINISTRATION | 13 RUNNING TRACK |
| 6 SERVICE | 14 DANCE |
| 7 GYMNASIUM | 15 MEDIA CENTER |
| 8 LOCKERS | |

LEVEL 3 FLOOR PLAN

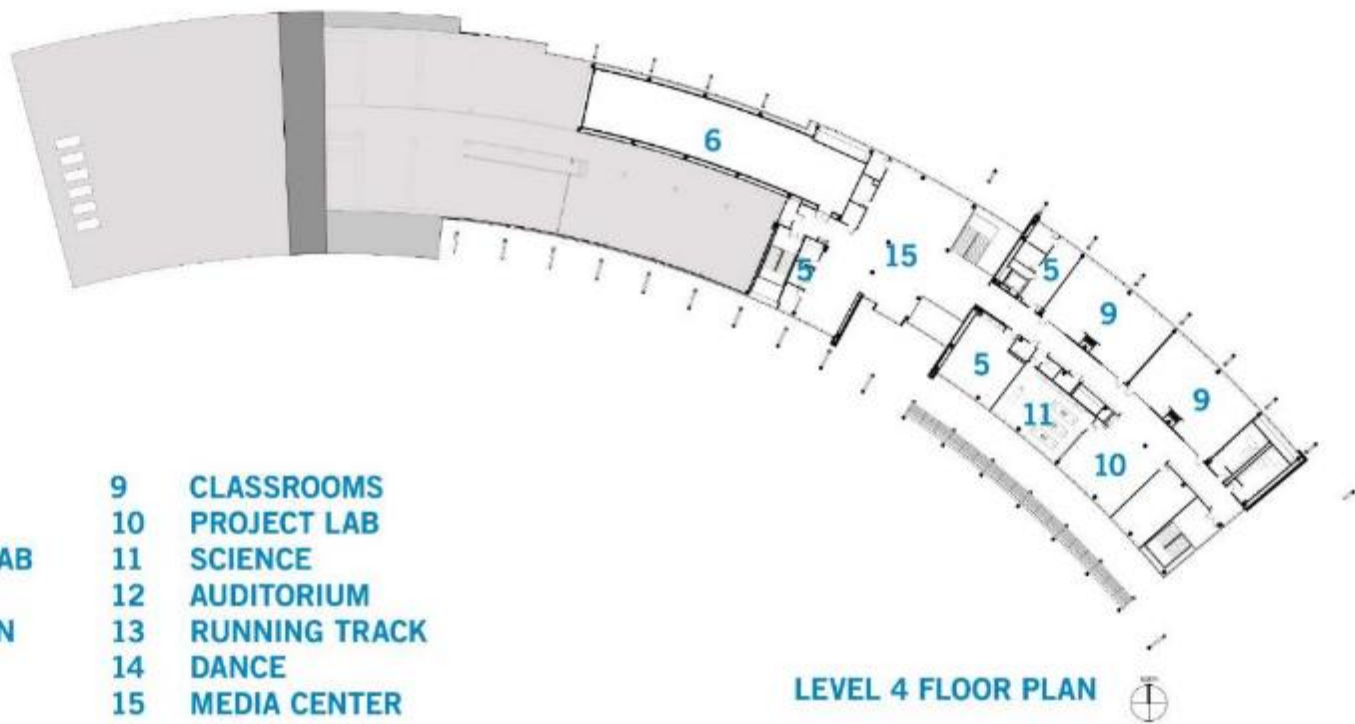

LEGEND

- | | |
|-------------------|------------------|
| 1 CAFETERIA | 9 CLASSROOMS |
| 2 KITCHEN | 10 PROJECT LAB |
| 3 CAREER TECH LAB | 11 SCIENCE |
| 4 MUSIC | 12 AUDITORIUM |
| 5 ADMINISTRATION | 13 RUNNING TRACK |
| 6 SERVICE | 14 DANCE |
| 7 GYMNASIUM | 15 MEDIA CENTER |
| 8 LOCKERS | |

LEVEL 4 FLOOR PLAN

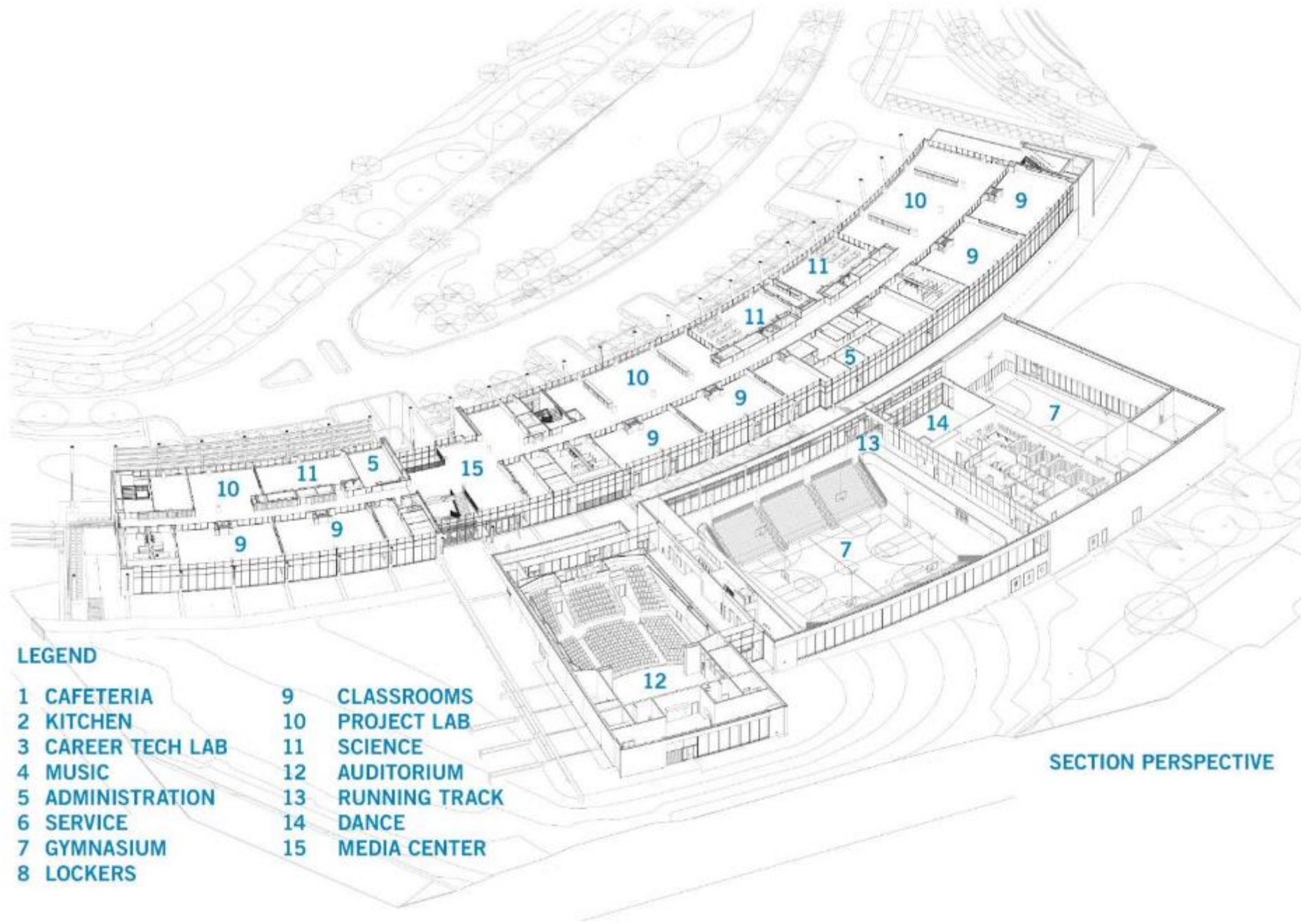

SECTION PERSPECTIVE

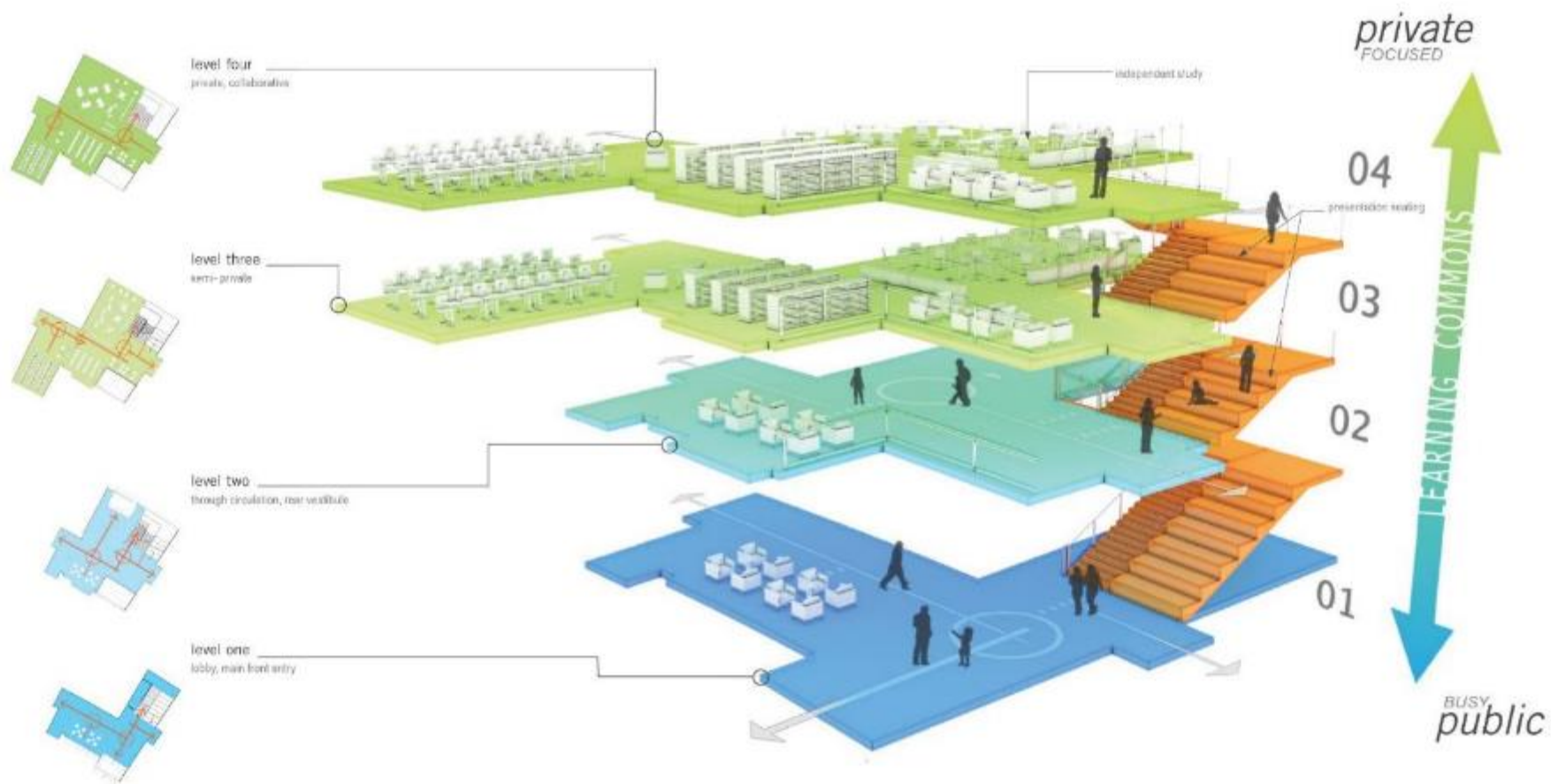

Exhibition of School Planning and Architecture

Project Data

Submitting Firm :	Perkins+Will
Project Role	Architect, Planner, Landscape Architect, Interior Designer, Branded Environments Designer
Project Contact	Barbara Crum
Title	Principal
Address	1315 Peachtree Street NE
City, State or Province, Country	Atlanta, Georgia 30309
Phone	404.443.7613
Joint Partner Firm:	N/A
Project Role	
Project Contact	
Title	
Address	
City, State or Province, Country	
Phone	

Other Firm:	Uzun+Case, LLC
Project Role	Structural Engineer
Project Contact	Jim Case
Title	Principal in Charge
Address	1230 Peachtree St NE #2500
City, State or Province, Country	Atlanta, Georgia 30309
Phone	678.553.5200

Construction Firm:	Newcomb & Boyd
Project Role	Mechanical, Electrical, Plumbing and Fire Protection Engineer
Project Contact	Bob Howell
Title	Principal in Charge
Address	303 Peachtree Center Avenue, NE Suite 525
City, State or Province, Country	Atlanta, Georgia 30303
Phone	404.730.8441

Exhibition of School Planning and Architecture

Project Details

Project Name	Charles R. Drew Charter School Junior and Senior Academy
City	Atlanta
State	Georgia
District Name	Atlanta Public Schools
Supt/President	Don Doran, Head of School/Principal
Occupancy Date	August 2014
Grades Housed	6-12
Capacity(Students)	1,000
Site Size (acres)	39 acres
Gross Area (sq. ft.)	205,375 sq. ft.
Per Occupant(pupil)	205 sq. ft.
gross/net please indicate	
Design and Build?	No
If yes, Total Cost:	n/a
Includes:	n/a
If no,	CM at Risk
Site Development:	\$3,500,000
Building Construction:	\$40,300,000
Fixed Equipment:	\$1,200,000
Other:	
Total:	\$45,000,000 (total construction cost)

Auditorium

Additional Information

The auditorium has a seating capacity of 525 and is used for performing arts and community events.



North Plaza stairwell

Additional Information

The North plaza connects the academic building to the gymnasium and auditorium and provides a dynamic setting for outdoor learning.

Because of the slope, a linear plaza in front of the theater and gym allows students to enter the main building's atrium at the second level. The plaza leads student down to the athletic field which provides ample space for the school's track and field, and soccer programs.



Interior stairwell with stadium seating

Additional Information

Interior Stairwell with stadium seating benches which allow students to work in small groups or independently. These benches are outfitted with power and wireless networking for unlimited access to technology. The white oak reclaimed wood used in the atrium stairs was sourced on site.



Learning Commons

Additional Information

The learning commons includes a variety of spaces for students, teachers, and visitors. Connecting all 4 floors are the unique stadium seating benches which allow students to work in small groups or independently, and they also serve as a presentation space at every floor level.

Reinforcing the vision of the school as well as enhancing the learning environment, we concretized the school's brand in response to their commitment to project-based learning: inquire, make, share. We incorporated this message into flexible display system for student presentations, the atrium staircase, and other walls and floors throughout the building.



Track and Field area



