

2014 Exhibition of School Planning and Architecture

Joplin Soaring Heights Elementary + East Middle Schools

One Building. Two Schools.

Joplin School District
Joplin, Missouri

Joplin Soaring Heights (section I)

**A TEACHER ASKED:
DOES THIS FEEL LIKE A SCHOOL?**

"No, to me it feels like happiness!"
- Joplin Student



Joplin Soaring Heights Elementary + East Middle Schools
One Building. Two Schools.

Joplin East Middle (section II)



Joplin Soaring Heights Elementary + East Middle Schools
One Building. Two Schools.

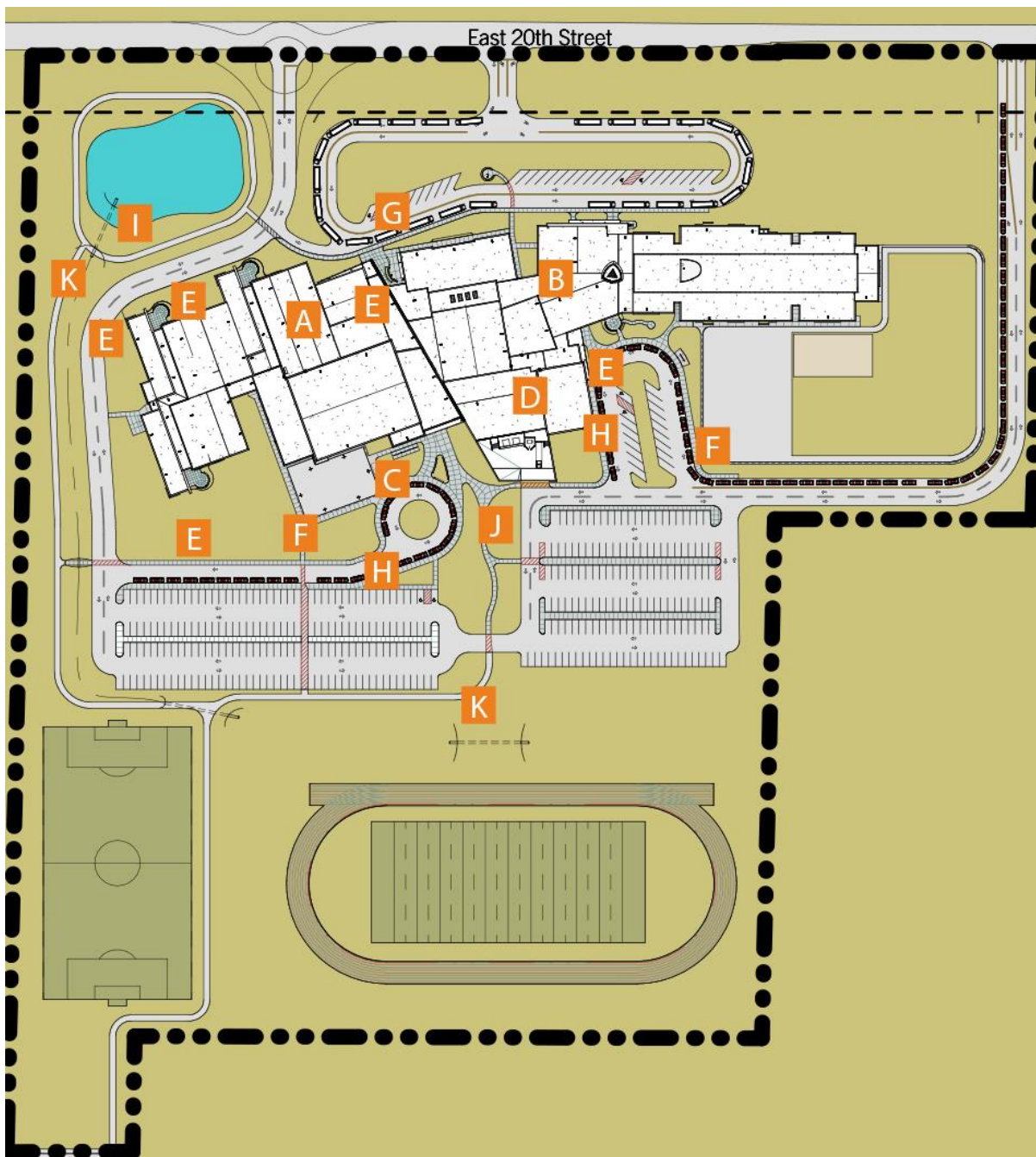

Joplin Soaring Heights
Elementary + East
Middle Schools
Site Diagram
One Building. Two Schools.

- A** MS main entry
- B** ES main entry
- C** MS secondary entry
- D** ES secondary entry
- E** Outdoor learning
- F** Outdoor play
- G** Bus drop-off
- H** Parent drop-off
- I** Outdoor learning lab/retention pond
- J** Receiving
- K** Walking trail

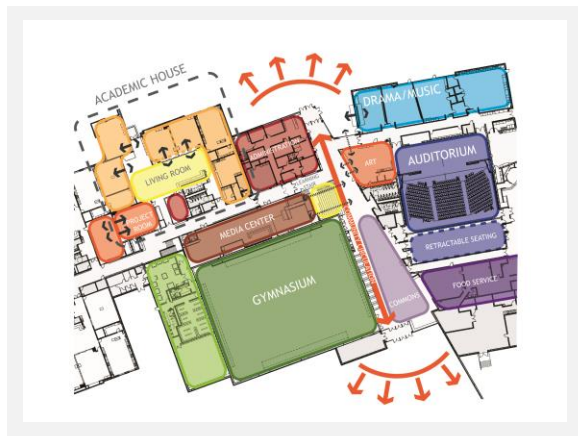

Joplin Soaring Heights and East Middle School Overall Floorplan

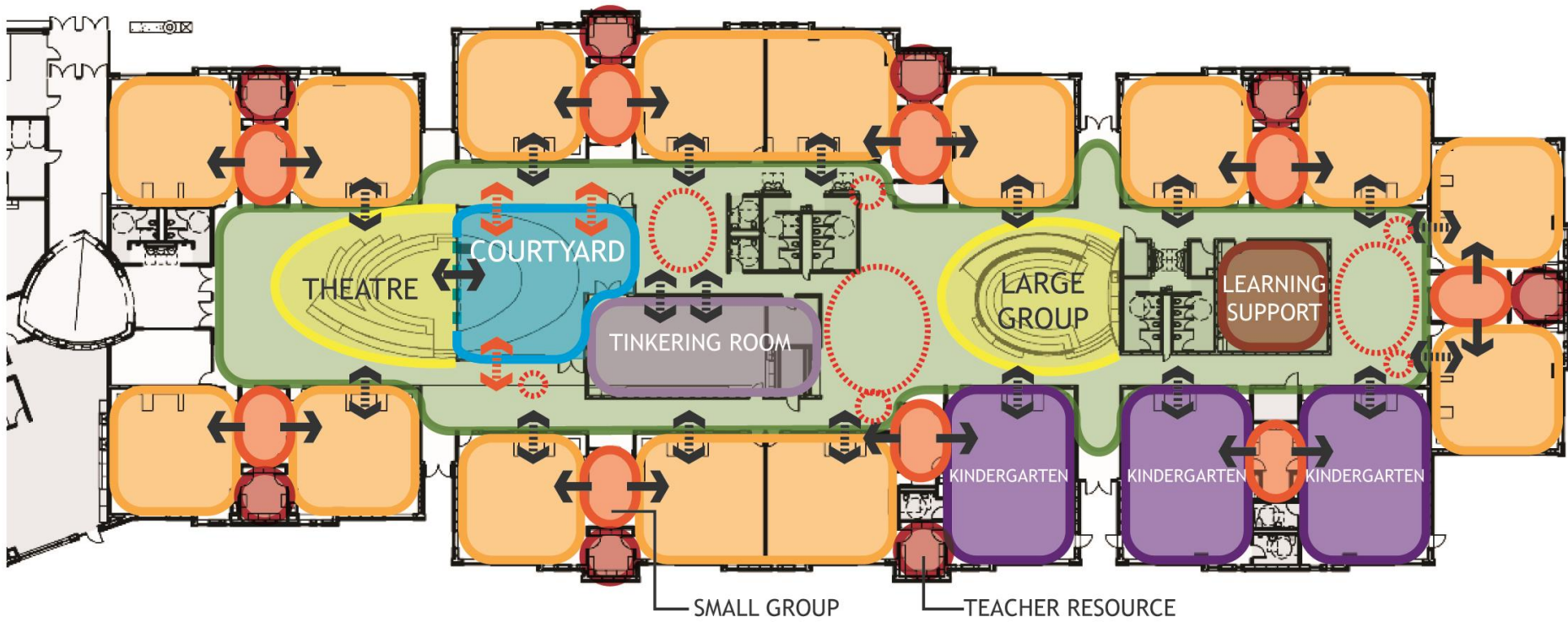

Joplin Soaring Heights School Floorplan



COMMUNITY ENVIRONMENT: **KEEPING THE COMMUNITY INTACT – OUR MISSION**

CAN A SCHOOL HELP REBUILD AND DRAW PEOPLE TO A COMMUNITY?
YES. IN JOPLIN, BOTH ARE HAPPENING!

Most projects don't get to have a role in helping keep a city and community together. We rarely get an opportunity to help support a large, very real goal such as this. But, for Joplin, it was a must. Without a school system, a community would fall apart. The people were already suffering enough and they needed to have a trusted piece of their lives back as soon as possible. It was imperative that the school district rebuild and do it quickly in order to keep its residents in Joplin.



Joplin Soaring Heights Elementary + East Middle Schools

One Building. Two Schools.

COMMUNITY ENVIRONMENT: NEIGHBORHOOD SCHOOL

Connecting Students to their Community:

The Joplin School District was the largest organization hit by the tornado and in order to keep the community from moving away, the school district had to get schools designed and built quickly or this community would be no more.

Provided an avenue to economic development/community redevelopment:

The schools in Joplin were so vitally important they could be equated to being an anchor tenant for the entire community. This anchor was needed before other revitalization could occur and was the real reason for the redevelopment to occur.

Engaged the community + gave ownership:

Even though the schedule and time allotments for meetings had to be condensed, we also honored the life issues each person was personally facing and this made their availability and contributions even more meaningful.

COMMUNITY ENGAGEMENT: GETTING OWNERSHIP + REDEFINING EDUCATION

Our process was mindful to include multiple students, teachers, administrative team members, community members, board members and anyone else we felt would help us dream and create a unique vision for Joplin. We included the administration, teachers, principals and board members in our process. We were a part of regular monthly meetings as well as special community forums to help keep everyone on the same page and seek input and direction from key groups. We also had special meetings for the community: we held several special meetings with the community in order to cull the community's ideas, needs, hopes and wants. A part of our design process included groups of children to help select colors and materials that best fit their educational needs. We formed a committee and named it Operation Rebuild – a team of a cross-section of key people representing the key constituents in the Joplin Community and Joplin School District. This important team of people met frequently and sometimes more than once daily in order to steward this entire effort. We wanted a team that would help everyone keep the promise of HOPE the touch point for every decision concerning the new elementary and middle school facility. Our goal was to make sure all key stakeholders and constituents' voice was at the table: Students, community members, administration, faculty, school board members, consultants, contractors and sub contractors.



DEVELOPING SUCCESSFUL 21ST CENTURY LEARNERS

Learning is **Personalized**: Recognizing, enabling and guiding each student to reach his or her potential.

Learning is **Active**: Applied project-based and exploratory with authentic, engaging real world context. The schools will provide an environment that inspires learners to become critical, independent thinkers -- stretching all learners at all levels. **Thru trust, empowerment and differentiated learning the schools will engage students minds, bodies and sense of wonder** to excel in project-based learning, problem solving and career skill development.

CONNECTING HOME + SCHOOL + COMMUNITY

Learning is **Engaging** : **Partnerships thru home, school, business and community will ensure that learning environments will be a valuable resource for current and future generations.** The schools will provide a home for the activities of the community. Community learning and parent resource centers (as well as storage spaces for various programs) will foster relationships and encourage life long learning.

ENCOURAGING A CULTURE OF COLLABORATION

Learning is **Collaborative**: We are all in this together. You should see the learning everywhere.

Learning is **Global**: Extending beyond the classroom to the school, the campus, the community, the country, and beyond. The schools will include a wide variety of open, inviting, fun and engaging indoor and outdoor learning environments and provide spaces for professional staff development. **It will leverage the opportunities to share resources, mentor and integrate a shared elementary + middle school campus -- allowing students to progress by their readiness** and share their knowledge with fellow students and teachers.

STRETCHING THE EXPECTATIONS-FOCUS ON THEIR FUTURE/NOTOUR PAST

Learning is **Joyful**: It is enabled by trust. It is comfortable and without pretension. Warm, safe and welcoming, the environment will maximize teaching and learning. Learning is **Stimulating**: Making use of the best resources available (human, technology, nature, etc.) **Flexibility and change is necessary for progress** and continuous improvement. The schools will **break out of the typical school mold** and provide a fun and engaging environment. The first impression will be warm, welcoming and inspiring, while still accomplishing safety and security needs. **The current and future's best educational practices will determine the organization of the environment** allowing for full engagement and continuous improvement by all students.

PROVIDING OPPORTUNITIES FOR ALL LEARNERS

Learning is **for Everyone**: Every learner has special needs. **All ages and all places, all can learn and are equally valued in the community of learners.** Learning is Flexible: **All students are unique and therefore deserve a unique education based on their readiness.** The schools will be naturally accessible for all students and provide spaces for special programs that are centrally located and integrated into student life.

SUSTAINABILITY-FLEXIBILITY-ADAPTABILITY

Learning is **Evolving**: As the demands of our culture evolve, the methods, tools + environments for learning must have the ability to adapt.

Learning is **Accountable**: Programs, facilities and educational decisions should recognize the long-term impact of operational costs, environmental impact and student success. The schools will focus on energy conservation and sustainable practices -- teaching the students to be globally aware and environmentally conscious. The focus will be maintained on education and **the building will have a natural ability to adapt and grow as programs and technology.**

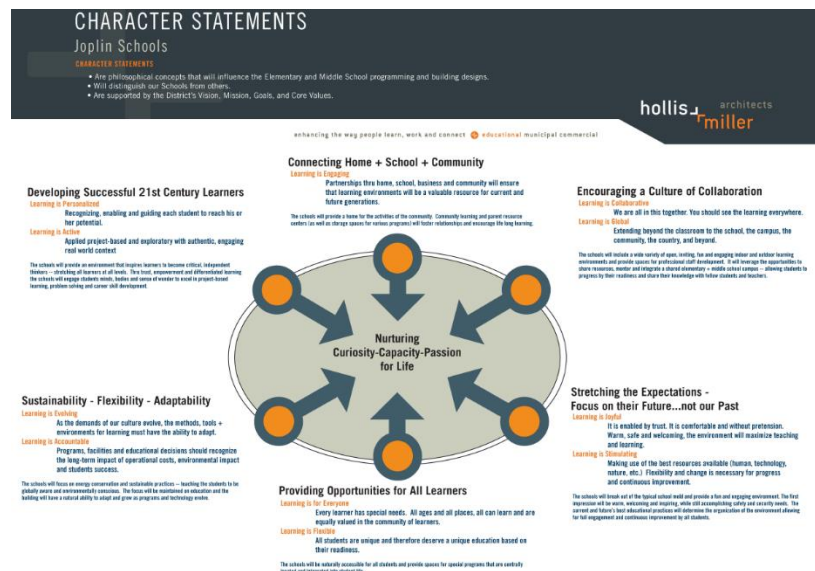

DESIGN VISION + GOALS

We design every project first in words. These Character Statements help provide mutually-agreed upon goals that the community understands and owns because it understands. These goals are supported by the design of each space throughout the entire project and tie back to one or more of the six character statements.

PLANNING: COMMUNITY USE + FLEXIBLE TEACHING + LEARNING

DESIGN GOAL + VISION THIS SPACE SUPPORTS: STRETCHING THE EXPECTATIONS-FOCUS ON THEIR FUTURE/NOT OUR PAST

Learning is **Joyful**: It is enabled by trust. It is comfortable and without pretension. Warm, safe and welcoming, the environment will maximize teaching and learning.

Learning is **Stimulating**: Making use of the best resources available (human, technology, nature, etc.) **Flexibility and change is necessary for progress** and continuous improvement. The schools will **break out of the typical school mold** and provide a fun and engaging environment. The first impression will be warm, welcoming and inspiring, while still accomplishing safety and security needs. **The current and future's best educational practices will determine the organization of the environment** allowing for full engagement and continuous improvement by all students.



Joplin Soaring Heights Theatre In the Park

Given the school's central location, it was important to develop a strong interconnection between the conjoined school and the community. Multiple aspects of the design foster this partnership:

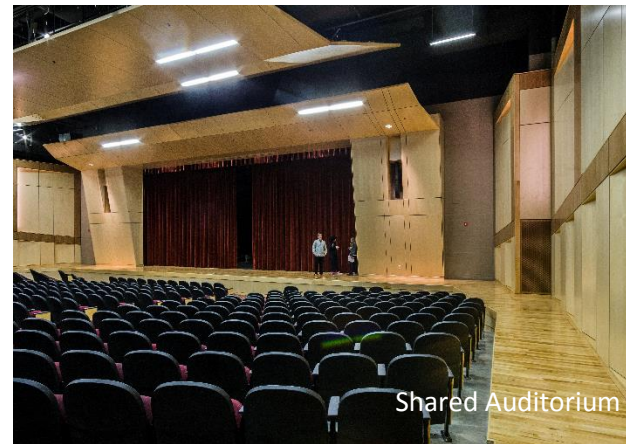

Shared Auditorium

The shared auditorium allows both elementary and middle school students and teams to have a large auditorium that most elementary schools and middle schools do not get to enjoy!



Joplin Soaring Heights Outdoor Learning Park

Our Outdoor Learning Park™ design provides another dual purposed learning environment and stage for student presentations, speeches, learning and community gatherings.

Joplin Soaring Heights Lighthouse

PLANNING: MAJOR MILESTONES – IN A CONDENSED PROJECT SCHEDULE

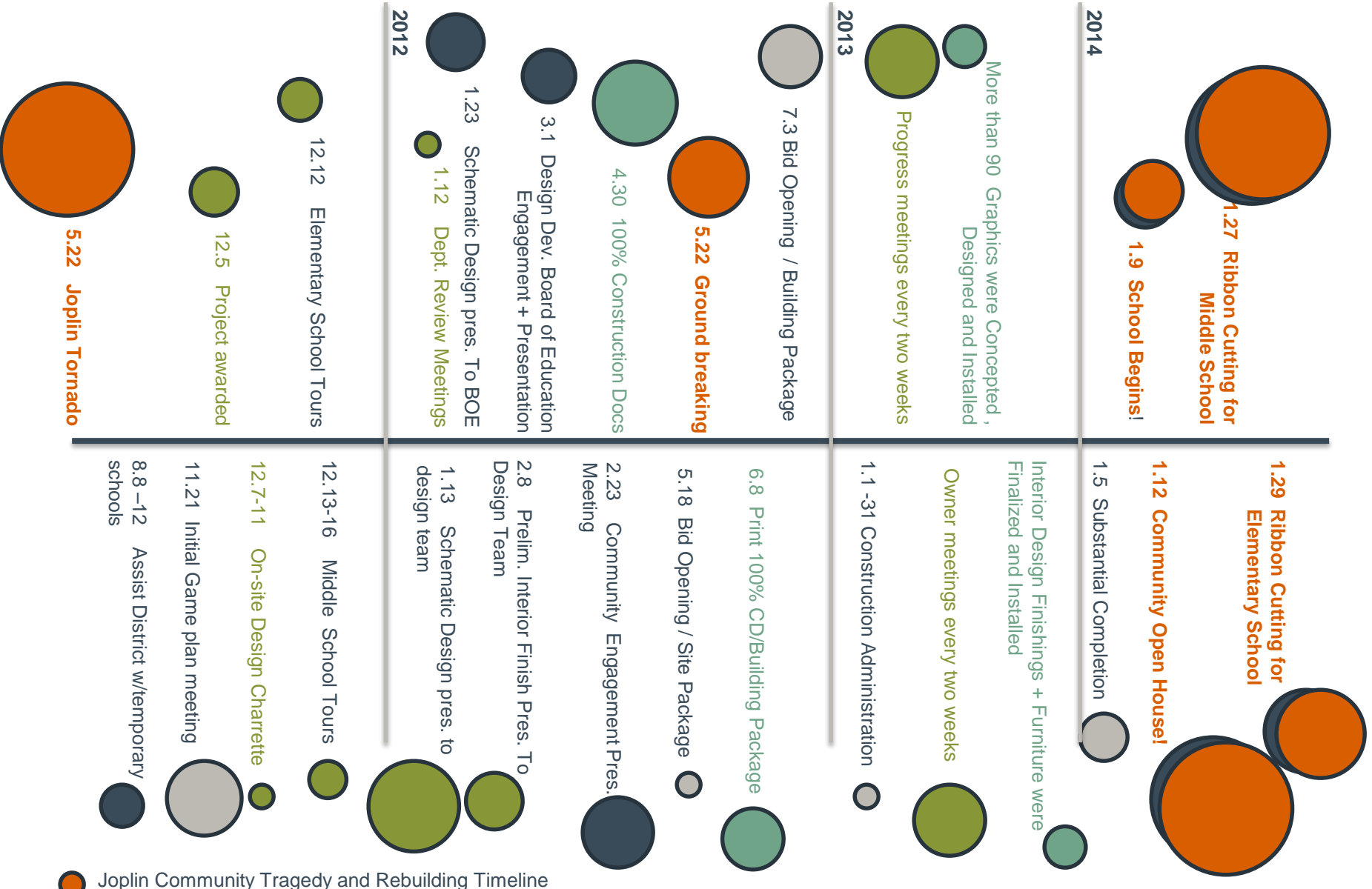

- Joplin Community Tragedy and Rebuilding Timeline
- Community Engagement
- Design Efforts + Client Collaboration
- Design Milestones
- Construction Event

LEARNING ENVIRONMENT: Students get to select the stage for their optimum learning advantage and enjoyment.

DESIGN GOAL + VISION THIS SPACE SUPPORTS: DEVELOPING SUCCESSFUL 21ST CENTURY LEARNERS

Learning is **Personalized**: Recognizing, enabling and guiding each student to reach his or her potential.

Learning is **Active**: Applied project-based and exploratory with authentic, engaging real world context. The schools will provide an environment that inspires learners to become critical, independent thinkers -- stretching all learners at all levels. **Thru trust, empowerment and differentiated learning the schools will engage students minds, bodies and sense of wonder** to excel in project-based learning, problem solving and career skill development.

This space was designed to support this goal: **Connect home, school and community.**

Designed to nurture learning, our Learning ParkSM was created to instill dreaming and possibility in the minds of the teachers and students and has both indoor and outdoor areas so the opportunities for learning are endless. It is the overall central area to the school. It is encased in classrooms. Like a real park set in nature, there are a variety of learning ecosystems to facilitate learning for every type of brain. Learning takes place in a light and color-filled space that engages the mind and body. Operable walls and adjacencies provide the flexibility needed to encourage new ways of thinking, sharing, teaching and absorbing.

LEARNING ENVIRONMENT: Brain-based learning design in every space maximizes teaching + student learning flexibility.

DESIGN GOAL + VISION THIS SPACE SUPPORTS: SUSTAINABILITY-FLEXIBILITY-ADAPTABILITY

Learning is **Evolving**: As the demands of our culture evolve, the methods, tools + environments for learning must have the ability to adapt.

Learning is **Accountable**: Programs, facilities and educational decisions should recognize the long-term impact of operational costs, environmental impact and student success. The schools will focus on energy conservation and sustainable practices -- teaching the students to be globally aware and environmentally conscious. The focus will be maintained on education and **the building will have a natural ability to adapt and grow as programs and technology.**



Joplin East Middle School Living Room



Joplin East Middle School Living Room

Middle School Students need wayfinding and we incorporated color themes to help them navigate. Flexible seating makes every learning neighborhood accommodating to any need.



Joplin East Middle School Living Room

Classrooms have glass walls that open or shut depending on the type of learning and collaboration being used. Here, students can integrate dual learning with variety of classes and topics.



Joplin East Middle School Cave Space

Small group collaborative + speech practicing with students and teachers working closely together provides for optimum understanding and mentoring up and down from teacher to student and student to student.

LEARNING ENVIRONMENT: COLLABORATIVE SHARING



Joplin East Middle Commons and Collaborative Booths

“When we think about the future...we have to think about technology. This kind of building is designed to facilitate the technology change because it has a lot of pieces in place for adapting for the new technology.”

- Daniel Holden, Joplin Teaching and Learning Coach

Flexible teaching and collaborative spaces: All classrooms have a shared small group learning space for more private personal interaction with teachers or peers that are private as well as public and we enhanced the flexibility with specific furniture choices.

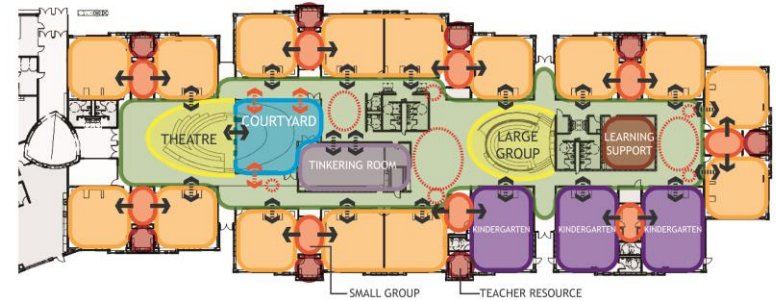

Educationally-driven design plans for the future: educationally driven design is always about the kids. We want to inspire learning and create opportunities for students and teachers alike, so the spaces we created were designed together with Joplin. They weren't our own ideas. They were the results of our collaborative sharing and processing the wonderful new aspirations in front of them. It's our desire that the students and teachers of Joplin are able to dream as big as they want and create fantastic futures for their lives and community. Our hopes were realized in just the simple chance to concept with them. In the end, we're the better architecture team because of their great hope for their community.

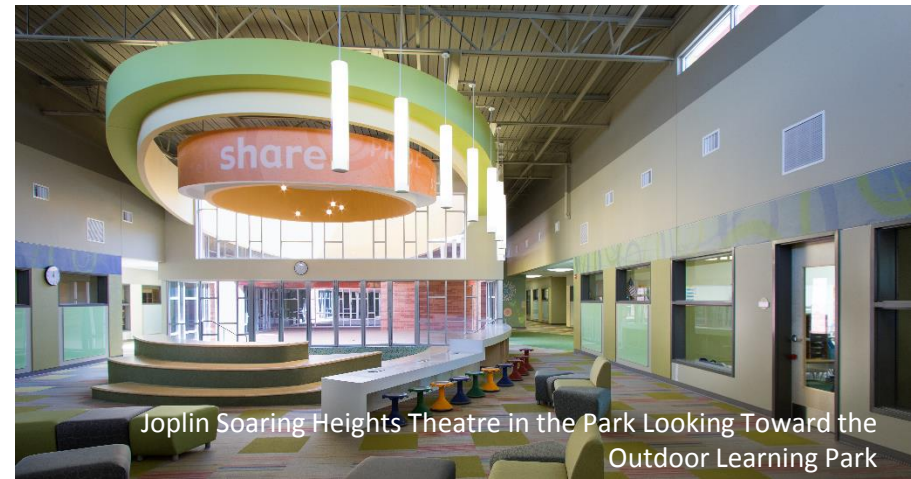

Joplin Soaring Heights Theatre in the Park Looking Toward the Outdoor Learning Park



Joplin East Middle School Small Group
Directive Learning Space



Joplin East Middle Commons + Collaborative
Genius Cafe



Joplin Soaring Heights
Media Center

LEARNING ENVIRONMENT: Collaborative, group, individual learning.

Collaborative spaces are incorporated throughout the entire building in a variety of learning settings : large, medium, small and one-on-one. For some, their favorite space for individual thinking or small group meetings is the Learning Stair. Each morning, we find students gathering here to talk about the game last night, activities they want to do together. It's becoming a nesting ground before breaking off to attend class. One of the unique features is our ADA space that overlooks the Learning Stair thru windows that open. We took time and gave special attention to making the space for those in wheelchairs the prime space in the Learning Stair area. Some have said that the best seats in the house are given to students with disabilities in Joplin! Throughout the whole building, we tried to make all ADA areas a prime spot -- the cool spot to be and the route in getting there is just as fun. For instance, in this learning stair area, the windows above open giving the students with disabilities the best seats in the house or like a stadium suite!



Joplin East Middle School Learning Stair
and the Best Seat in the House, the ADA Suite

PHYSICAL ENVIRONMENT: PLACES FOR EVERY TYPE OF LEARNER'S SUCCESS.

Creating community gathering areas is an important part of this design. No one owns any space in the school so any group of classes or classmates is able to find the space that affords them the best learning or collaborating space possible! Most all classrooms open to the Learning ParksSM and have a shared small group learning space for more private personal interaction with teachers or peers that are private as well as public.

Joplin Soaring Heights Treehouse



DESIGN GOAL + VISION THIS SPACE SUPPORTS: DEVELOPING SUCCESSFUL 21ST CENTURY LEARNERS

Learning is **Personalized**: Recognizing, enabling and guiding each student to reach his or her potential.

Learning is **Active**: Applied project based and exploratory with authentic, engaging real world context. The schools will provide an environment that inspires learners to become critical, independent thinkers -- stretching all learners at all levels. **Thru trust, empowerment and differentiated learning the schools will engage students minds, bodies and sense of wonder** to excel in project-based learning, problem solving and career skill development.

Joplin Soaring Heights Treehouse



Joplin Soaring Heights Area Around the Treehouse



Joplin Soaring Heights Living Room Neighborhood



Joplin Soaring Heights Classroom



DESIGN GOAL + VISION THIS SPACE SUPPORTS CONNECTING HOME + SCHOOL + COMMUNITY

Learning is **Engaging**. **Partnerships thru home, school, business and community will ensure that learning environments will be a valuable resource for current and future generations.** The schools will provide a home for the activities of the community. Community learning and parent resource centers (as well as storage spaces for various programs) will foster relationships and encourage life long learning.



Auditorium – Shared by both Joplin Soaring Heights, Joplin East Middle School and the Community

PHYSICAL ENVIRONMENT:

Fiscally- Responsible Design

The unique features of this auditorium provide more fiscal responsibility than most auditoriums. We wanted to make the space usable for a variety of purposes – not just one for one size of crowd. The surprise element is the retractable theatre seating with vertical acting dividing partition (skywall) that subdivides and creates greater shared educational flexible learning space between elementary and middle schools. We wanted the school district to use this space for more than just large events and show once again that the district is a responsible steward of resources.



GREEN FEATURES + RATIONALE

- Daylighting
- Low VOC finishes or ZERO VOC
- No added urea formaldehyde in wood products and in insulation products such as fiberglass
- Efficient HVAC system
- Efficient lighting
- Joint use of facilities
- Preservation of open space due to the efficiency of a joint building
- The use of local/regional and recycled materials
- Efficient water fixtures
- Retention pond used for irrigation
- Native landscaping
- Low-E glass/glazing

Joplin Soaring Heights Entrance to the Outdoor Learning Park – Clear Outside Views from Interior Classrooms

PHYSICAL ENVIRONMENT: **Sustainability**

The Joplin School District said they didn't want to go after LEED but the district did decide to definitely look at environmental green elements. The Joplin School Administration wanted to be responsible in terms of making the building as efficient as possible.

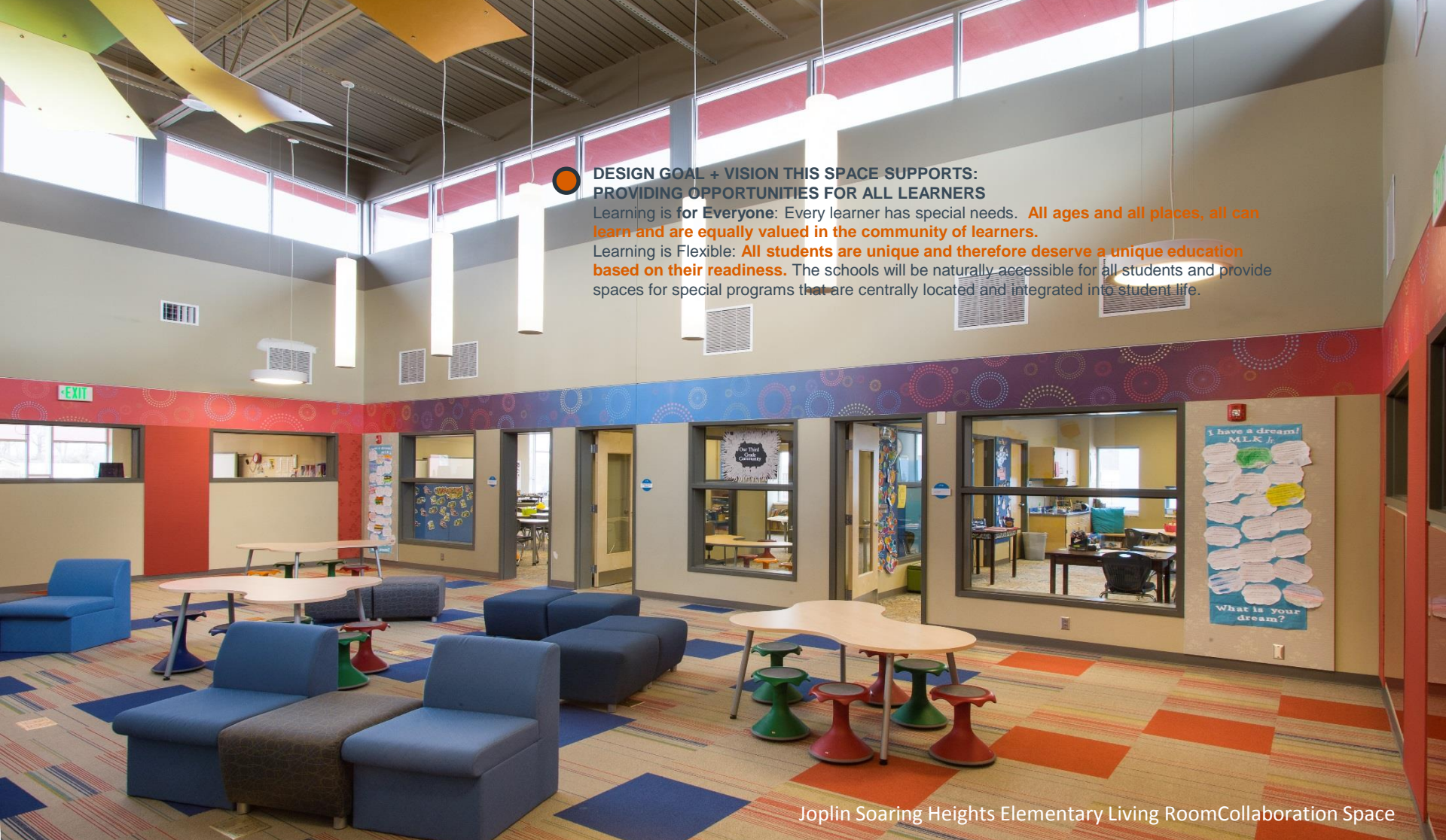

**DESIGN GOAL + VISION THIS SPACE SUPPORTS:
PROVIDING OPPORTUNITIES FOR ALL LEARNERS**

Learning is **for Everyone**: Every learner has special needs. **All ages and all places, all can learn and are equally valued in the community of learners.**

Learning is Flexible: **All students are unique and therefore deserve a unique education based on their readiness.** The schools will be naturally accessible for all students and provide spaces for special programs that are centrally located and integrated into student life.

Joplin Soaring Heights Elementary Living Room Collaboration Space

PHYSICAL ENVIRONMENT: Materials

EAST MIDDLE SECTION: New two-story steel framed construction with metal stud/gypsum board walls. Within the middle school one FEMA safe room is incorporated into the overall building design. The safe room also serves as locker room space, weight room, and auxiliary gymnasium for the middle school students. The space is constructed of cast-in-place concrete walls and roof and is equipped with self-contained restrooms. **SOARING HEIGHTS SECTION:** New 1-Story steel framed construction with metal stud/gypsum board walls. Within the elementary school two FEMA safe rooms are incorporated into the overall building design. One of the safe rooms doubles as classroom space and serves the students and occupants of the elementary school. The other safe room doubles as the elementary school gym and serves the entire community of Duquesne, Missouri. Both safe rooms are constructed of cast-in-place concrete walls and roof and are equipped with self-contained restrooms.



DESIGN GOAL + VISION THIS SPACE SUPPORTS:

STRETCHING THE EXPECTATIONS-FOCUS ON THEIR FUTURE/NOT OUR PAST

Learning is **Joyful**: It is enabled by trust. It is comfortable and without pretension. Warm, safe and welcoming, the environment will maximize teaching and learning.

Learning is **Stimulating**: Making use of the best resources available (human, technology, nature, etc.) **Flexibility and change is necessary for progress** and continuous improvement. The

schools will **break out of the typical school mold** and provide a fun and engaging environment. The first impression will be warm, welcoming and inspiring, while still accomplishing safety and security needs.

The current and future's best educational practices will determine the organization of the environment allowing for full engagement and continuous improvement by all students.

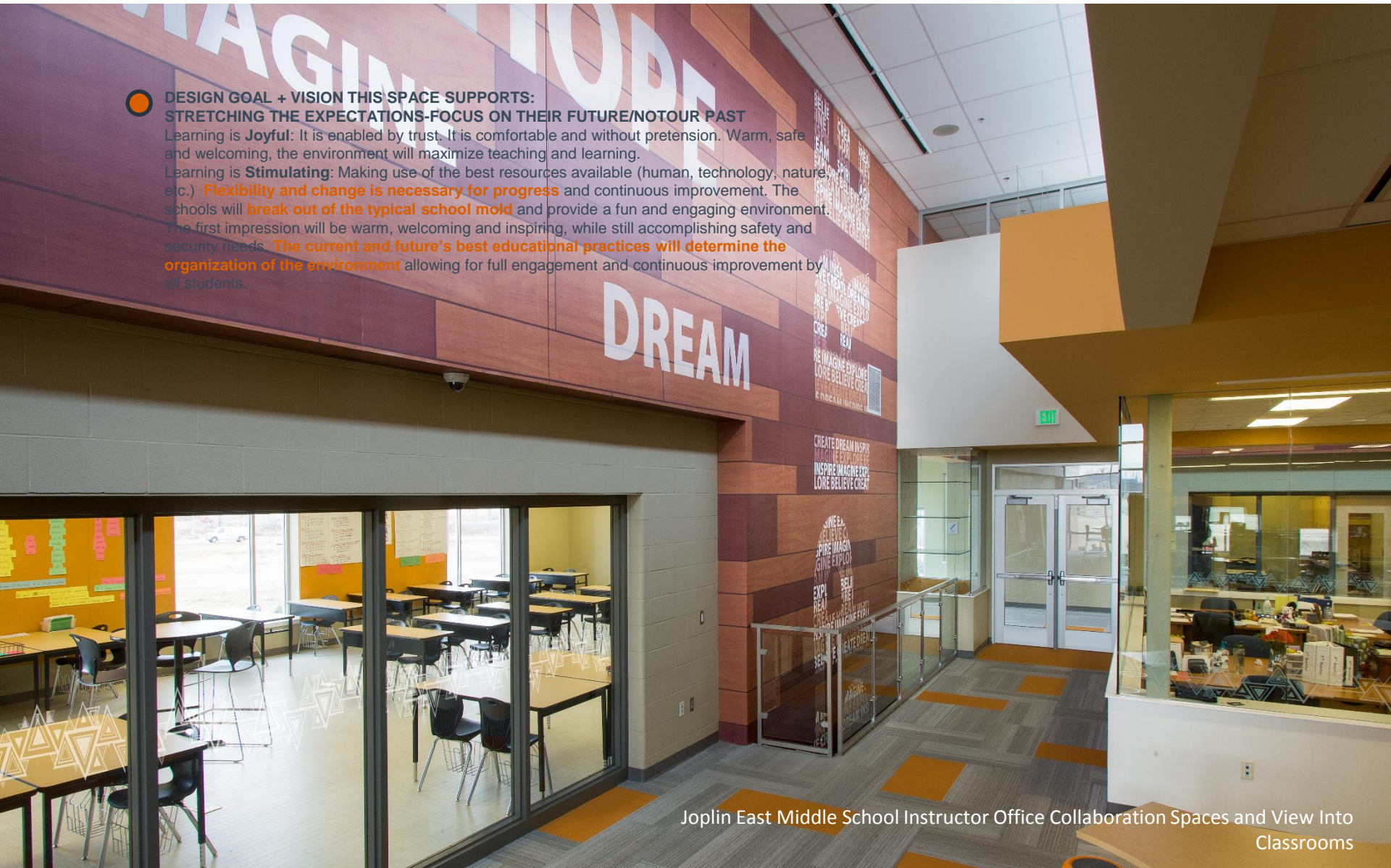

Joplin East Middle School Instructor Office Collaboration Spaces and View Into Classrooms

PHYSICAL ENVIRONMENT:

Graphics

Thought-provoking learning tools, such as text and graphics were incorporated into the design and placed throughout the new building to reinforce the mission and vision and were used to help enhance the focus on creativity, collaboration and inspire curiosity.



Joplin East Middle School

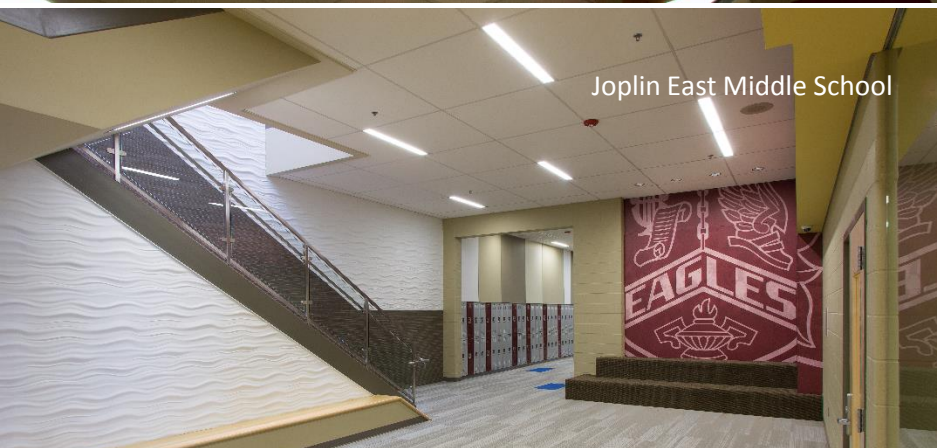

Joplin East Middle School

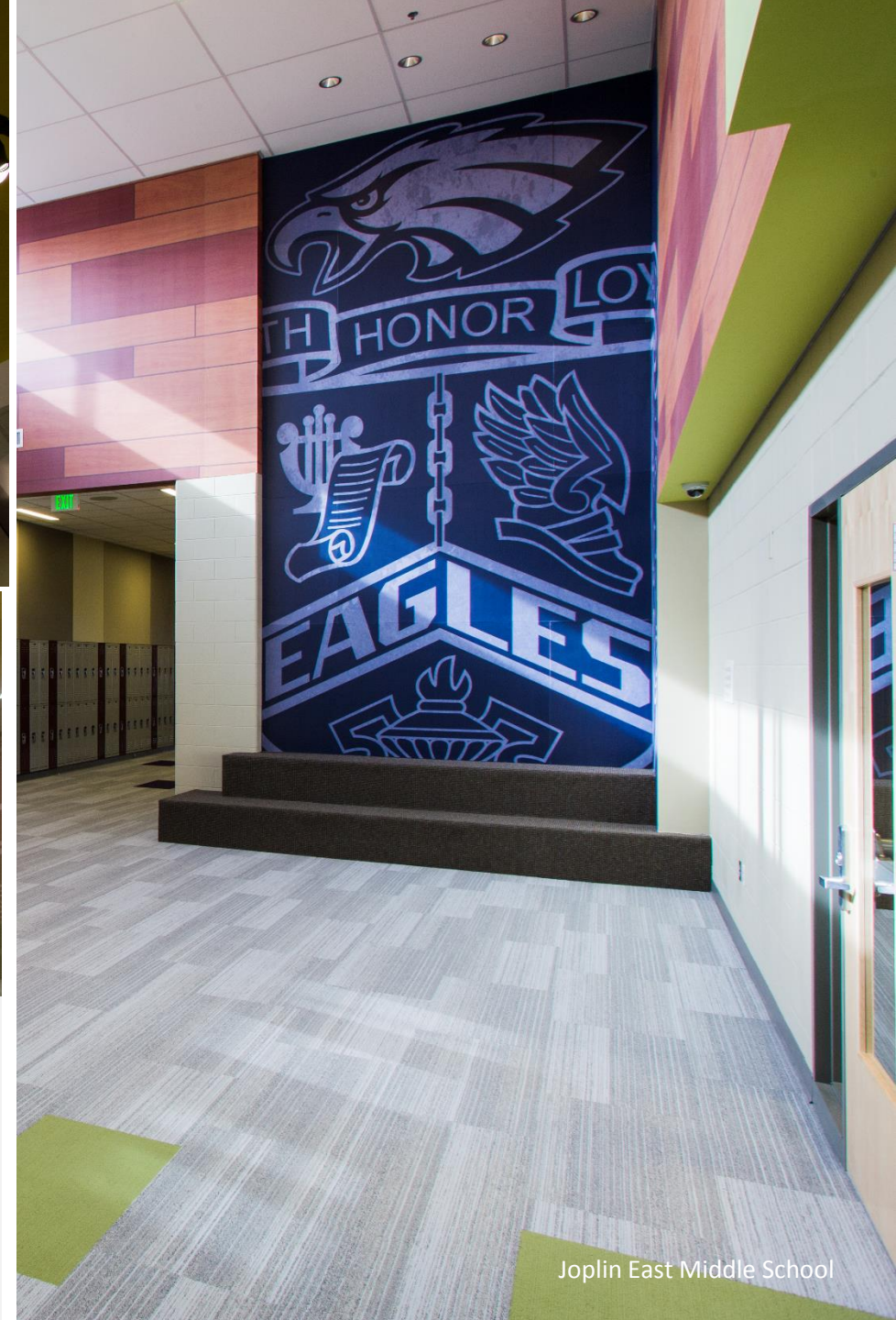

Joplin East Middle School

PHYSICAL ENVIRONMENT: Graphics

While honoring the past and still pushing forward, we needed to bring in touch points from the past generations and keep their hopeful, bright outlook front and center through graphic design. The Joplin Eagle is an important image for the entire school district, so we incorporated it on every floor in colors pertaining to that floor in wayfinding design palettes to make it easier for middle school students to navigate.

Exhibition of School Planning and Architecture

Project Data

Submitting Firm :	Hollis + Miller Architects
Project Role	Architecture + Structural + Interior + Graphic Design Firm
Project Contact	John Brown, AIA, DBIA
Title	Partner-In-Charge
Address	220 N.W. Executive Way
City, State or Province, Country	Lee's Summit, MO 64063
Phone	816.525.5600

Joint Partner Firm:	Brainspaces
Project Role	Planning
Project Contact	Amy Yurko, AIA
Title	Owner
Address	1100 N. California Avenue
City, State or Province, Country	Chicago, IL 60622
Phone	773.531.3221

Other Firm:	
Project Role	
Project Contact	
Title	
Address	
City, State or Province, Country	
Phone	

Construction Firm:	Universal Construction
Project Role	Construction
Project Contact	Jason Bishop
Title	Project Manager
Address	11200 W. 79 th Street
City, State or Province, Country	Lenexa, KS 66214
Phone	913.342.1150

Exhibition of School Planning and Architecture

Project Details

Project Name	Joplin Soaring Heights + East Middle Schools
City	Joplin
State	Missouri
District Name	Joplin School District
Supt/President	Dr. C.J. Huff
Occupancy Date	January 1, 2014
Grades Housed	K-5 and 6-8 (one building – two schools)
Capacity(Students)	Elementary: 450 students.; Middle: 750 students
Site Size (acres)	34.85 total acres
Gross Area (sq. ft.)	Elementary: 65,290 sq. ft; Middle: 157,274 sq. ft.
Per Occupant(pupil)	185 sq. ft.
gross/net please indicate	Elementary: 19%, Middle: 24%; Total: 23%
Design and Build?	No
If yes, Total Cost:	
Includes:	
If no,	
Site Development:	\$3,770,375
Building Construction:	\$40,180,046
Fixed Equipment:	\$1,227,437
Other: Casework	\$833,978
Total:	\$43,950,421



Thank you!

Joplin Soaring Heights and East Middle Schools
One Building. Two Schools.