

# 2013 Exhibition of School Planning and Architecture

## **Fluvanna High School**

Fluvanna County, Virginia

# FLUVANNA HIGH SCHOOL





# FLUVANNA HIGH SCHOOL

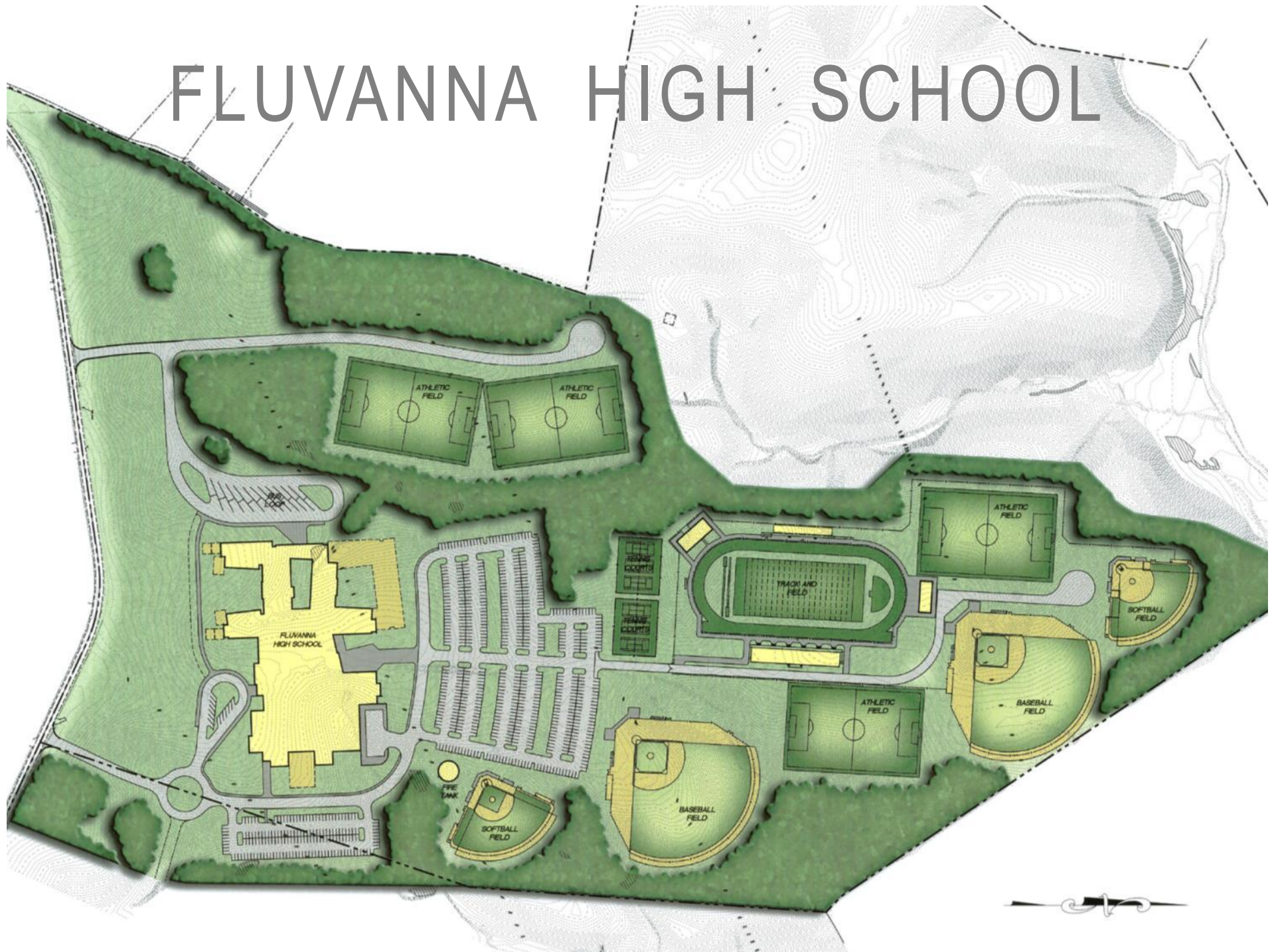





## COMMUNITY ENVIRONMENT

County representatives spoke of their vision of the new school in terms like “sleek and modern” and “environmentally responsive” while stating above all that it would exude the pride and respect the community has for its citizens and their future. The auditorium, gym, fitness center and meeting spaces welcome the community into what can truly be described as a civic center serving all.

The school is broken into three learning communities, with a fourth possible for the future: world health, global communications, and technology. So a student in the health sciences would get access to all core curriculum—math, English, and social studies—then also have adjacent access to science, nursing, emergency medical technical, and health and human science facilities. Global communications would, for their part, connect to technology in communications, broadcast, and journalism areas.



# COMMUNITY ENVIRONMENT

The school boasts a gymnasium that seats 2,000 for basketball and volleyball. There is also an auxiliary gym, which the school was able to afford by realizing savings elsewhere. Directly accessible from the outside, it can be used by the community, the same as a fitness center at the front of the school. Outside, near the field house with its locker rooms and refreshment amenities are the competition fields and football stadium with artificial turf, another of the additive alternates.







## LEARNING ENVIRONMENT

The organization of the building celebrates and encourages independence and interaction among students. Technology within Fluvanna High School supports collaboration rather than isolating individuals from one another.

Each learning community provides a variety of collaboration spaces for students and teachers to use for project-based learning outside of the “typical” classroom space. Project libraries and conference spaces are located near assistant principal offices and student lockers to allow for collaborative opportunities to expand into circulation areas where individuals and small groups can meet comfortably and team.

The functional and efficient main administration suite supports individual work and conferencing spaces, equipped with integrated furniture systems designed for ergonomic comfort and design elegance. Assistant principals are located throughout the learning communities, encouraging a tighter connection, cooperation, and interaction with students and faculty.

Teachers enjoy a highly professional office suite located within each learning community. These suites contain individual work space, teaming areas, storage, and utility support designed to encourage inter-disciplinary cooperation and collaboration.

While the new Fluvanna High School is equipped with state of the art technology and integrated security systems aimed at protection of the community and its children, the real security is established by the feeling that comes with freedom to explore and control your own destiny in the learning communities.





# LEARNING ENVIRONMENT

All classrooms, multi-purpose spaces, project libraries, as well as the tiered seminar labs have flexibility to adjust based on group size, activity, and functional needs. The flexible furniture arrangements are designed for reconfiguration from single user to multiple users in group activities without special assistance from building operators.

Classrooms and project libraries are easily modified from de-centralized teaching and heavy group work to lecture-style within minutes. Each of the double-sized, technology-rich project libraries are set up for ease of division with stacking, retractable walls so groups from 25 to 75 can be accommodated.

The building is also designed to accommodate expansion as the population demands. When students entered in the fall of 2012, the capacity was 1630 (including the integrated career and technical education suites). The core facilities are designed to allow expansion to 1800 with the simple addition of classroom space. The master plan for the building and site prepares for an ultimate enrollment of 2500 should Fluvanna need and desire to maintain a single high school.

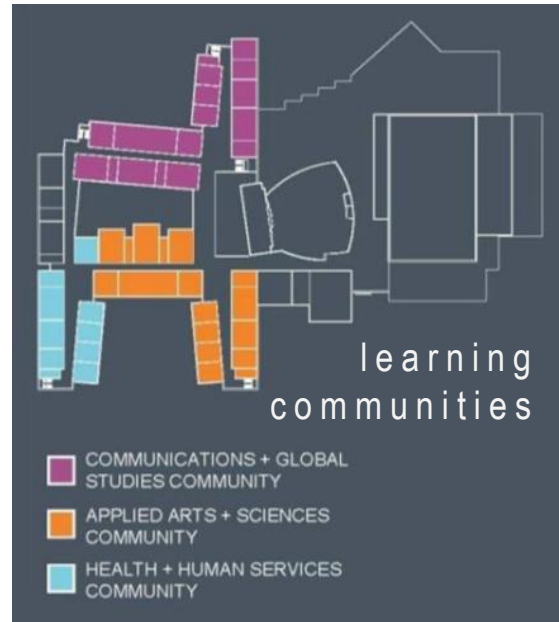



# PHYSICAL ENVIRONMENT

Fluvanna County's new high school combines a comprehensive approach to real world experiences. With a focus on flexible learning for all students, there are a variety of spaces arranged for lecture, seminar, small group, large group, project-based, and independent exploration. All elements of the interior environment, from comfort and illumination to color and technology, support the learning experience while giving teachers and students a clear picture of how the building works effectively and efficiently.

All spaces are enhanced by an abundance of natural light with passive devices to both shade and project into the building. The occupancy and illumination sensors in each space automatically adjust light levels based on natural light contribution. Sensors also adjust heating and cooling to the number of people in the space, maximizing comfort and energy efficiency.

Every learning space is equipped with acoustic treatment that reduces ambient noise while a distributed sound enhancement system assures that all students can hear instruction properly. Projection systems in each space provide presentation and interactive capabilities in a single unit, eliminating the expense and encumbrance of a projector and interactive board. Any notes or illustrations applied to the standard marker board can be downloaded with a simple stroke of the keyboard, making traditional note-taking even easier. This system allows for greater student participation and interaction - keys to true understanding.







## PHYSICAL ENVIRONMENT

Just as technology and comfort are an important background to the learning environment, color and texture are thoughtfully spread throughout the building to invigorate space and give a sense of place to all who pass through the new school. The patterns used in the environmentally-respectful linoleum flooring combine with natural colors to elicit the heritage of an advanced agronomic community. The patchwork of color and grid remind the visitor of the planted fields viewed from a flyover, a common sight in the County of Fluvanna.







## PLANNING PROCESS

Fluvanna is a moderately sized county for Virginia insofar as population goes. Nonetheless, it has tremendous plans for the future of its schools. The central-Virginia rural community's secondary education program is already well-regarded, having earned a place on the 2012 U.S. News & World Report list of top schools in the country, with a third of its students participating in advanced placement programs. And that ranking was based on the performance of students attending a 1970s-era school facility. Now, with a brand new high school, the future is wide open. "We call this our new beginning," says Fluvanna High School Principal James Barlow.

The community's planning process began more than a decade ago. Projections at the time presented the county with two options: build a smaller supplemental school or build a larger and expandable new replacement facility. The county chose the latter. The high school is programmed and designed as a community focal point serving county residents as well.





# PLANNING PROCESS

County and school leaders pursued the design of Fluvanna County's new high school as a center piece of the future development of the County and its facilities. The site is part of a 1000 acre plot of land acquired by the Board of Supervisors more than a decade ago with the intent of providing for the education, recreation and business of all residents. Located near the historic Rivanna River, the site is very nearly at the geographic center of the County.

Ultimately, the high school is just one part of a cascade of physical improvements to the county's school system. To accommodate the anticipated growth in the number of intermediate and elementary students, the plan is to renovate the old high school into a middle school and convert the middle school to provide space for elementary students.







- PROFESSIONAL SPACES
- INFORMAL LEARNING
- SPECIALTY
- PROJECT BASED
- GENERAL INSTRUCTION

SECOND FLOOR (ENTRY LEVEL)



# Exhibition of School Planning and Architecture

## Project Data

Submitting Firm :	BCWH Architects
Project Role	Architecture Design
Project Contact	Roger D. Richardson, AIA, REFP
Title	Principal
Address	1840 West Broad Street, Suite 400
City, State or Province, Country	Richmond, VA 23220
Phone	804-788-4774

Joint Partner Firm:	N/A
Project Role	
Project Contact	
Title	
Address	
City, State or Province, Country	
Phone	

Engineers	
Education & Technology	Eperitus
Civil & Landscape	Timmons Group
Structural	Stroud Pence & Associates
MEP	Obenchain, Linkous, Daniels & Sowick
Food Service	Foodservice Consultants Studios

Construction Firm:	Nielson Builders
Project Role	Contractor
Project Contact	
Title	
Address	1588 Early Road
City, State or Province, Country	Harrisonburg, VA
Phone	(540) 434-7376



# Exhibition of School Planning and Architecture

## Project Details

<b>Project Name</b>	Fluvanna High School
<b>City</b>	Fluvanna County
<b>State</b>	Virginia
<b>District Name</b>	Fluvanna County Public Schools
<b>Supt/President</b>	Gena Keller
<b>Occupancy Date</b>	Fall 2012
<b>Grades Housed</b>	8-12
<b>Capacity(Students)</b>	1630 (core facilities designed to expand to 1800, master planned for additional enrollment of 2500)
<b>Site Size (acres)</b>	165 acres
<b>Gross Area (sq. ft.)</b>	314,389 SF
<b>Per Occupant(pupil)</b>	193 SF
<b>gross/net please indicate</b>	
<b>Design and Build?</b>	Yes
<b>If yes, Total Cost:</b>	\$60,090,373
<b>Includes:</b>	
<b>If no,</b>	
<b>Site Development:</b>	
<b>Building Construction:</b>	
<b>Fixed Equipment:</b>	
<b>Other:</b>	
<b>Total:</b>	



FIRST FLOOR

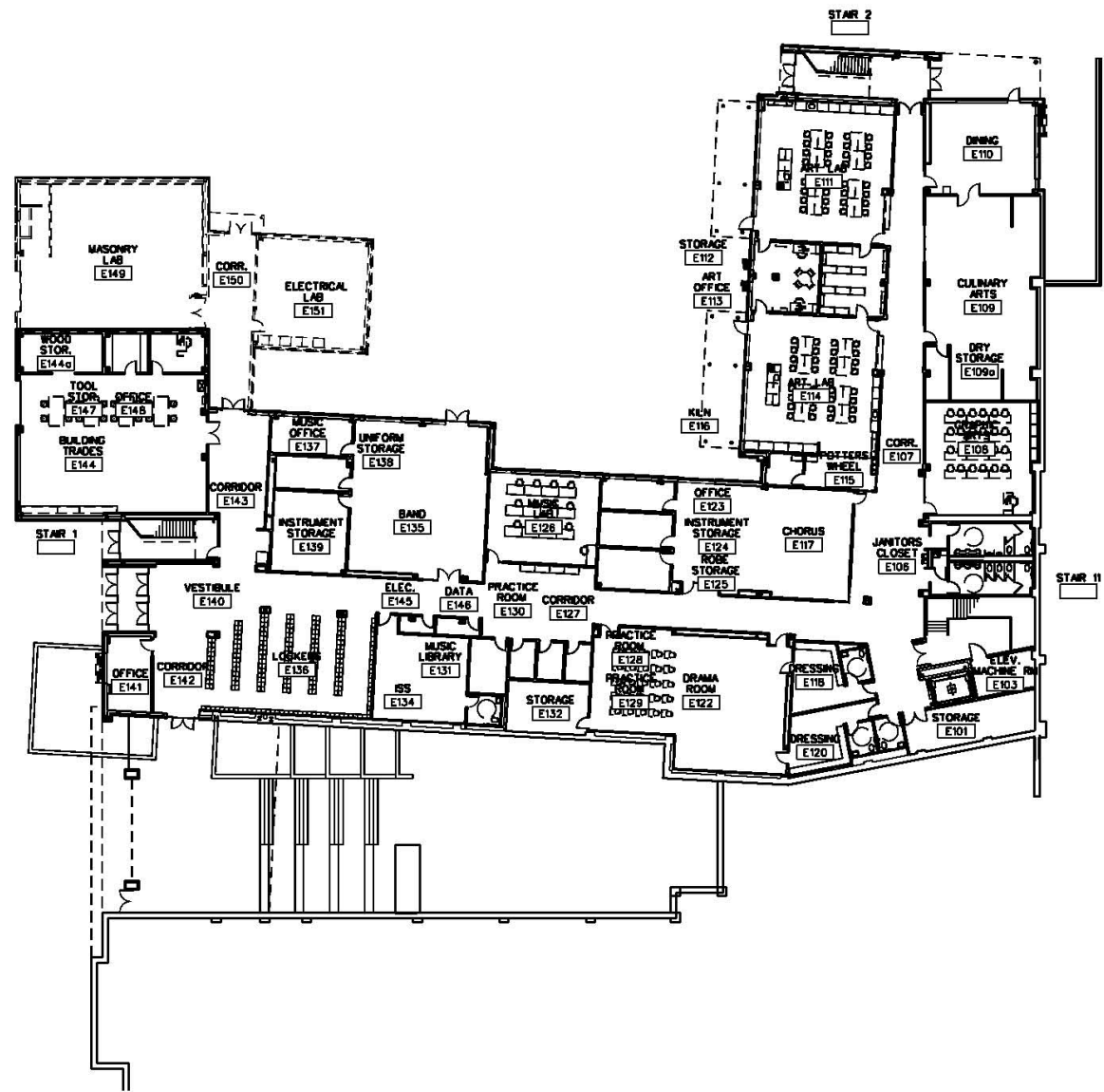



SECOND FLOOR (ENTRY LEVEL)

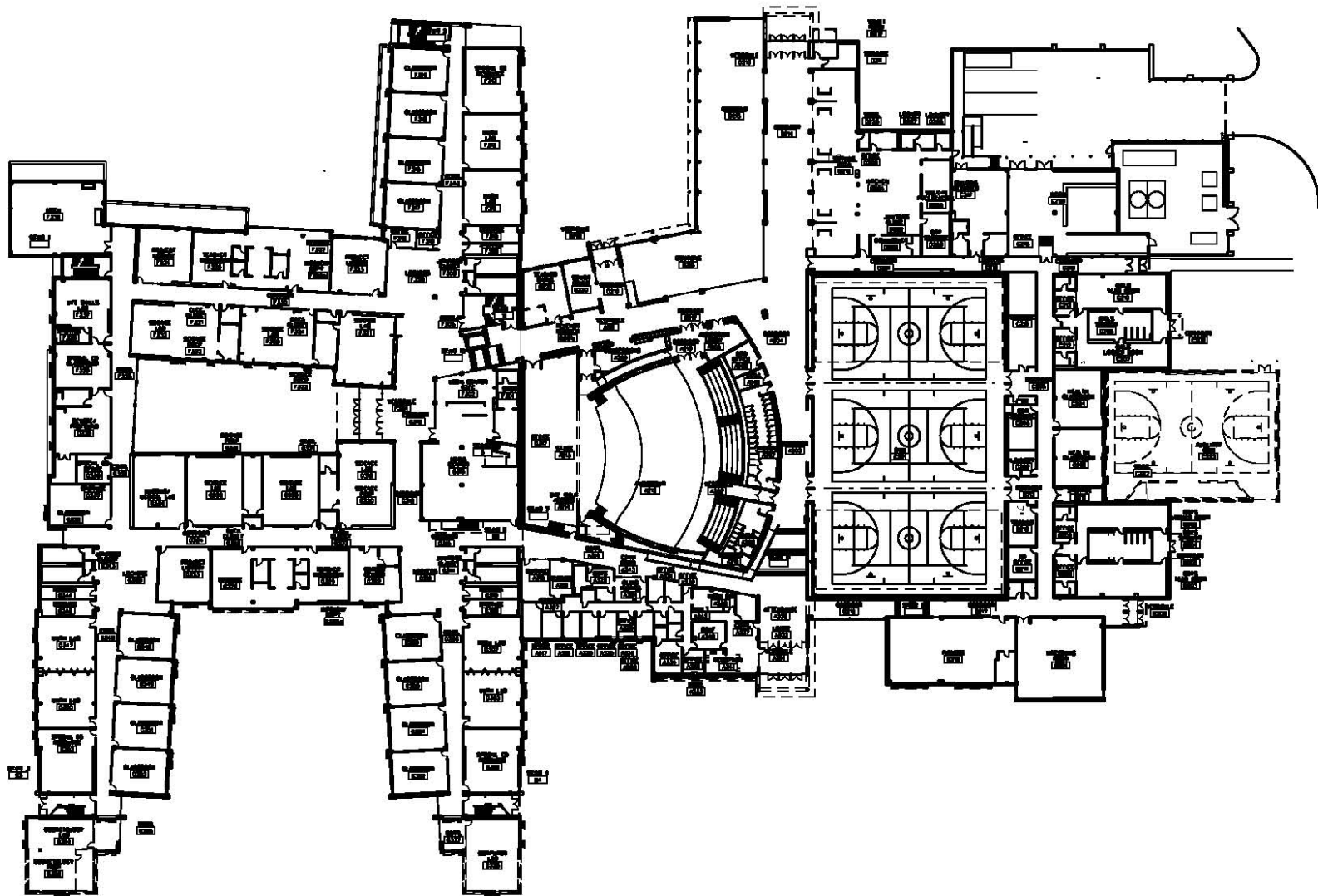

THIRD FLOOR

