

# 2012 Exhibition of School Planning and Architecture

## Carroll Middle School

Southlake, Texas  
New Construction  
Project of Distinction Award  
Natex Architects

# Carroll Middle School



## Carroll Middle School - Plaza

### Community Environment:

The new Carroll Middle School was designed as a community friendly facility that allows for an easy and controlled interaction of students, parents and visitors.

Clearly defined circulations permit a simple reading of the adjacent spaces and organizes the flow and it also facilitates the control by the staff personnel.

After hour spaces, such the Cafeteria /Stage and Library, bring the community, neighbors, students and faculty members of the school close together creating a sense of a big family that helps to build a solid relationship that benefits all.





# Carroll Middle School – Learning Spaces

## Learning Environment:

The campus has also been designed with state of the art teaching tools in every classroom and the flexibility of the structure of the building to evolve with the educational requirements of the future. The design has maximized the usage of every space. One example of this is the design of the stage off of the drama classroom which allows the stage to function as the black box for drama class.





# Carroll Middle School

## Physical Environment :

The new high performance Carroll Middle School in Southlake, Texas has excited Carroll ISD taxpayers, faculty, staff and students with the design allowing for logical and functional applications of sustainable features. They all enjoy the spaces in and around the building as the natural daylight cast its glow throughout the building.



# Carroll Middle School

## Physical Environment :

This campus has a 460KW Solar Array which came to the school district through grants. The project also utilizes LED lighting, daylight harvesting and Geothermal HVAC. This design is indicating so far a reduction of energy consumption of approximately 70-85%, which is critical with school district budget requirements.





# Carroll Middle School

## Planning Process:

Communication was the key during the planning process not only at the beginning phase but during the design phase as well. Local government, community, school staff and students played an important role to achieve a great design.

Due to time constraints the construction of the site started before the final building design was finished. This helped to meet the district requirement for completion time.

The composition of each elevation is unique based on the exterior site conditions and room function, but nonetheless very harmonious in its whole. The cafetorium and media center/library are placed on the north elevation to allow plenty of natural daylight through large glazing systems. Windows facing south are managed with large over hangs or louvers.



# Exhibition of School Planning and Architecture

## Project Data

Submitting Firm :	Natex Architects
Project Role	Project Architect
Project Contact	Carolina Weitzman
Title	President / Principal in Charge
Address	2500 Wilcrest
City, State or Province, Country	Houston, TX 77042
Phone	713-975-9525

Joint Partner Firm:	
Project Role	
Project Contact	
Title	
Address	
City, State or Province, Country	
Phone	

Other Firm:	
Project Role	
Project Contact	
Title	
Address	
City, State or Province, Country	
Phone	

Construction Firm:	Bartlett Cocke General Contractors
Project Role	Contractor
Project Contact	Steven McCleskey
Title	Vice President of Operations
Address	2028 E. Ben White Blvd. Ste. 200
City, State or Province, Country	Austin, TX 78741
Phone	512-326-4223



# Exhibition of School Planning and Architecture

## Project Details

<b>Project Name</b>	New Carroll Middle School
<b>City</b>	Southlake
<b>State</b>	TX
<b>District Name</b>	Carroll Independent School District
<b>Supt/President</b>	David Faltys
<b>Occupancy Date</b>	August 2011
<b>Grades Housed</b>	7 & 8
<b>Capacity(Students)</b>	750
<b>Site Size (acres)</b>	24.6 Acres
<b>Gross Area (sq. ft.)</b>	167,000
<b>Per Occupant(pupil)</b>	223 sf/student
<b>gross/net please indicate</b>	
<b>Design and Build?</b>	No
<b>If yes, Total Cost:</b>	
<b>Includes:</b>	
<b>If no,</b>	
<b>Site Development:</b>	\$3,500,000
<b>Building Construction:</b>	\$30,500,000
<b>Fixed Equipment:</b>	
<b>Other:</b>	
<b>Total:</b>	\$34,000,000

# Carroll Middle School



The design and features of the school create a place where learning becomes an exciting experience. The site has plenty of covered outdoor spaces and nature areas to encourage outdoor learning.



# Carroll Middle School

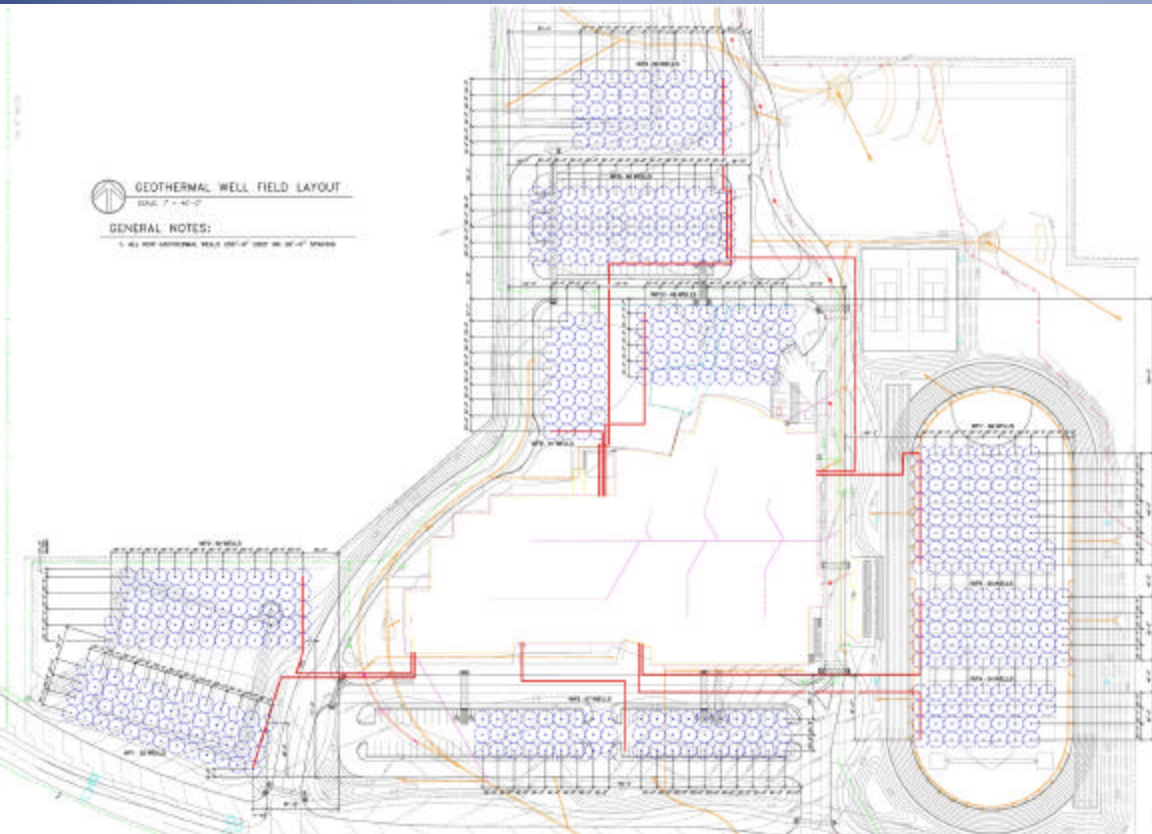

The geothermal wells for HVAC encompasses the majority of the site utilizing space underneath parking lots and athletic fields.

The campus has also included in the design a water well system for irrigation requirements of the athletic features of the site.

